

Twenty-Sixth Annual Meeting  
AMERICAN ASSOCIATION  
OF ENDODONTISTS

April 17, 18, 19, 20, 1969  
Pick Congress Hotel  
Chicago, Illinois

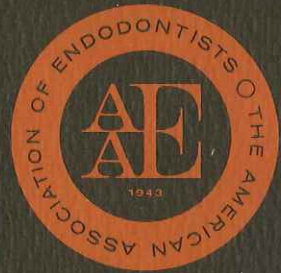

CHICAGO PICASSO



## INDEX

AAE President Samuel S. Patterson — "Welcome".....	1
Officers and Executive Committee.....	2
Photographs .....	4-5
Summary of Program	
Thursday .....	6
Friday .....	6-7
Saturday .....	7-8
Sunday .....	8-9
Entertainment and Special Events .....	10
Program Details	
Friday .....	11 thru 18
Luncheon With Learning.....	14-15-16
Saturday.....	19 thru 24
Edgar Coolidge Memorial Luncheon.....	21
Sunday .....	24 thru 26
Scientific Exhibits .....	27
Commercial Exhibits .....	27
Exhibit Floor Plan.....	28
Committee Appointments .....	29 thru 32

# President's Message



Welcome to the Twenty-Sixth Annual Meeting of the American Association of Endodontists. The prime mission of this organization is to keep its membership informed of new and better techniques and theories in the management of teeth with diseased pulps and periradicular tissue. The notion of therapy based on biologic concepts places endodontics among the fastest growing branches of dental medicine. And as you can see, Dr. James W. Bynum and his numerous

committees and sub-committees have arranged an excellent program to justify your attendance. The program is rich in talent both in clinical endodontics and in the basic sciences.

Few phases of dentistry have captured the practitioner's interest and desire to better serve his patient in the way that endodontics has. The acceptance of endodontic therapy has been staggering. The general practitioner and endodontist are swamped with demands for treatment of diseased teeth which only a short time ago would have been condemned to surgical removal. It is impossible for the universities to fulfill all of the demands placed upon them for post-graduate and graduate education in endodontics. For this reason alone, it is important for our members to supplement their education by taking advantage of this program to learn what is new or different in the treatment of the diseased pulp.

To construct a program of this magnitude, the Program Committee and Local Arrangements Committee started their preparations over a year ago. The Congress Hotel was selected five years ago as our meeting site. I need not tell you the infinite details and arrangements made for your pleasure; the scientific program and social activities should speak for themselves.

I do want to thank all of those associated with planning and presenting this program. Thanks, also, to all of the members of A.A.E. for helping me make the 1968-69 year another monument to the advancement of endodontics.

Samuel S Patterson, *D.D.S., M.S.D.*

## OFFICERS

SAMUEL S PATTERSON.....	<i>President</i>
THOMAS C. STARSHAK.....	<i>Honorary President</i>
WARREN J. HEDMAN.....	<i>President Elect</i>
JOHN F. BUCHER.....	<i>Vice President</i>
ROBERT A. UCHIN.....	<i>Secretary</i>
DUDLEY H. GLICK.....	<i>Treasurer</i>
I. B. BENDER.....	<i>Scientific Editor</i>

## HISTORIAN

VINCENT B. MILAS

## EXECUTIVE COMMITTEE

### 1971

MICHAEL A. HEUER  
RICHARD M. MOODNIK  
JULIAN L. KELLY

### 1970

HARRY BLECHMAN  
CHARLES A. SCOTT, JR.  
NGUYEN T. NGUYEN

### 1969

JOSEPH H. MERRELL  
ADRIAN J. SAMPECK  
ANDREW E. MICHANOWICZ  
EDWIN C. VAN VALEY.....*Immediate Past President*

## AMERICAN BOARD OF ENDODONTICS

LOUIS I. GROSSMAN, <i>Chairman</i>	JOHN DOWSON
GEORGE G. STEWART, <i>Secretary</i>	JACOB B. FREEDLAND
M. B. AUERBACH	HARRY J. HEALEY
JAMES B. BYNUM	MILTON SISKIN
BERTRAM L. WOLFSOHN	

## Past Presidents

*W. CLYDE DAVIS	1943
RALPH F. SOMMER	1944
ROBERT G. KESEL	1945
*E. G. VAN VALEY	1946
MAYNARD K. HINE	1947
LOUIS I. GROSSMAN	1948
*ELMER A. JASPER	1949
*RAYMOND L. GIRARDOT	1950
*GEORGE G. SHARP	1951
F. D. OSTANDER	1952
L. A. LUCAS	1953
N. WEIR BURKMAN	1954
HARRY J. HEALEY	1955
JOHN R. PEAR	1956
GEORGE C. HARE	1957
GEORGE G. STEWART	1958
J. HENRY KAISER	1959
PAUL P. SHERWOOD	1960
GLENN R. BROOKS	1961
VINCENT B. MILAS	1962
JAMES H. SHERARD, JR.	1963
J. B. FREEDLAND	1964
HENRY S. SCHMIDT	1965
JOHN I. INGLE	1966
EDWIN C. VAN VALEY	1967

### HONORARY MEMBERS

MARY C. CROWLEY	B. NYGAARD OSTBY
SIR E. WILFRED FISH	RALPH F. SOMMER
WALTER HESS	HAROLD STANLEY
*EDGAR D. COOLIDGE	

### LIFE MEMBERS

A. FLOYD ANDERSON	BENJAMIN W. MEIMAN
JOHN D. BARAB	H. H. PEARSON
HENRY A. BARTELS	JOHN R. PHARR
O. C. HIGH	S. M. RAFISH
SAUL LEVY	PERCY J. ROSS
GEORGE W. LORENZ	D. G. SIMMONS
A. A. PAPERMASTER	JESSE TRAGER

\*Deceased



SAMUEL S PATTERSON  
*President*



JOHN F. BUCHER  
*Vice President*



DUDLEY H. GLICK  
*Treasurer*



ROBERT A. UCHIN  
*Secretary*



**I. B. BENDER**  
*Scientific Editor*



**WARREN J. HEDMAN**  
*President Elect*



**HAROLD GERSTEIN**  
*Local Arrangements*



**JAMES W. BYNUM**  
*Program*

# Summary of Program-1969

## THURSDAY, APRIL 17th

- 9:00 A.M.-5:00 P.M. Endodontics Research Seminar  
Meeting — Carter Room  
Lunch — Plaza Room
- 9:00 A.M.-5:00 P.M. Executive Committee Meeting  
Columbian Room
- 12:00 Noon Executive Committee Luncheon  
Victorian Room
- 1:00 P.M.-6:00 P.M. Registration  
Florentine Reception Foyer
- 6:00 P.M.-8:00 P.M. A.A.E. Reception — Cocktail Party  
Florentine Room

## FRIDAY, APRIL 18th

- 7:30 P.M. New Member Orientation Breakfast  
Washington Room
- 8:00 A.M.-5:00 P.M. Registration  
Florentine Reception Foyer
- 9:00 A.M.-5:00 P.M. Scientific & Commercial Exhibits  
Buckingham & Lincoln Rooms
- 3:00 P.M. Trustees-Endowment and Memorial Foundation  
Music Room
- 8:50 A.M.-12:00 Noon Scientific Session  
Florentine Room
- 8:50 A.M. Opening Ceremonies

### DIFFERENTIAL DIAGNOSIS & RECENT PULP FINDINGS

Dr. Bertram L. Wolfsohn, *Session Chairman*

- 9:00 A.M. The Enigma of the Periapical Radiolucency  
William G. Shafer, D.D.S., M.S.



- 10:00 A.M.** Diagnostic Possibilities Common to the Endodontist and Otolaryngologist  
Richard Kurtz, M.D.
- 11:00 A.M.** Should Steroids Be Used in Pulp Therapeutics?  
Harold R. Stanley, D.D.S., M.S.
- 12:00 Noon** LUNCHEON WITH LEARNING  
Gold Room  
Herbert Schilder, D.D.S., *Chairman*
- 2:00 P.M.-5:00 P.M.** Scientific Session  
Florentine Room
- ENDODONTIC TREATMENT  
CONSIDERATIONS  
Dr. Charles A. Scott, Jr., *Session Chairman*
- 2:00 P.M.** The Latest Evidence on the Psychology of Pain  
Eugene E. Levitt, Ph.D.
- 3:00 P.M.** Drug Therapy in Surgical Endodontics  
Daniel M. Laskin, D.D.S., M.S.
- 4:00 P.M.** Cleaning and Shaping Root Canals  
Herbert Schilder, D.D.S.

### SATURDAY, APRIL 19th

- 7:30 A.M.** Meet The Board Breakfast  
Washington Room
- 9:00 A.M.-5:00 P.M.** Scientific & Commercial Exhibits  
Buckingham & Lincoln Rooms
- 9:00 A.M.-4:00 P.M.** Registration  
Florentine Reception Foyer
- 9:00 A.M.-12:00 Noon** Scientific Session  
Florentine Room
- ENDODONTIC TREATMENT  
CONSIDERATIONS  
Dr. George G. Stewart, *Session Chairman*
- 9:00 A.M.** Endodontic Implants  
Donald R. Morse, D.D.S.
- 9:30 A.M.** Surgical Principles in Endodontia  
Robert B. Shira, Major General, D. C.,  
U. S. Army

## SATURDAY, APRIL 19th

- 10:30 A.M.** General Anesthesia in Surgical and Non-Surgical Endodontic Treatment  
E. James Best, D.D.S., and  
Robert Bragman, M.D.
- 12:00 Noon** The Edgar D. Coolidge Memorial Lecture  
Gold Room  
Address by Dr. Maynard K. Hine
- 2:00 P.M.-4:00 P.M.** PROJECTED CLINICS & TABLE CLINICS
- Projected Clinics — Clinical  
Plaza Room  
George B. Travers, D.D.S., *Session Chairman*
- Projected Clinics — Scientific  
Florentine Room  
B. F. Gurney, D.D.S., *Session Chairman*
- Table Clinics  
Parkview, Columbian & Music Rooms  
Lonnie C. Sibley, D.D.S., *Session Chairman*
- 4:00 P.M.** Business Meeting  
Florentine Room
- 6:00 P.M.** Pre-Banquet Reception  
Belmont & Francis I Room
- 7:00 P.M.** Installation Banquet — Dance  
Gold Room

## SUNDAY, APRIL 20th

- 8:30 A.M.-12:00 Noon** Registration  
Florentine Reception Foyer
- 8:30 A.M.-12:00 Noon** Scientific & Commercial Exhibits  
Buckingham & Lincoln Rooms
- 9:00 A.M.-5:00 P.M.** American Board of Endodontics  
Written Examination  
Plaza Room
- 9:00 A.M.-5:00 P.M.** American Board of Endodontics  
Oral Examinations  
Belmont, Columbian & Washington Rooms

- 8:30 A.M.-12:00 Noon** Scientific Session  
Florentine Room  
Dr. Vincent B. Milas, *Session Chairman*
- 8:30 A.M.** Post-Treatment Endodontic Pain  
William H. Clem, D.D.S., M.S.D.
- 9:15 A.M.** Endodontic-Restorative Interrelationships  
Max Kornfeld, D.D.S.
- 10:15 A.M.** Current Status of Adhesive Dental Materials  
and Films  
Ralph W. Phillips, M.S., D.Sc.
- 11:15 A.M.** The Production of High Quality Transparencies  
and Prints of Dental Radiographs  
Ben Seidler, D.D.S.
- 12:00 Noon-3:00 P.M.** Executive Committee Meeting  
Avenue Room East

# *Entertainment and Special Events*

**THURSDAY, APRIL 17, 1969**

**LADIES PROGRAM**

**Informal Tea (Complimentary) — 2:00 P.M. - 4:00 P.M.**

Mrs. Dominic Fiscarelli's Suite

**A.A.E. Reception-Cocktail Party — 6:00 P.M. - 8:00 P.M.**

Florentine Room

**FRIDAY, APRIL 18, 1969**

**New Member Breakfast — 7:30 A.M.**

Washington Room

**Ladies Program — 12:00 Noon**

Luncheon "Springtime in Chicago"

Business Meeting — Favors & Door Prizes

Plaza Room

**SATURDAY, APRIL 19, 1969**

**Meet the Board Breakfast — 7:30 A.M.**

Washington Room

**LADIES PROGRAM**

**Free for Shopping**

**Pre-Banquet Reception — 6:00 P.M.**

Belmont & Francis I Room

**Installation Banquet-Dance — 7:00 P.M.**

Gold Room

# Program Details

**FRIDAY MORNING, APRIL 18, 1969**

**8:50 A.M. - 12:00 Noon**

## **SCIENTIFIC SESSION**

Florentine Room

**8:50 - 9:00**

## **OPENING CEREMONIES**

Greetings from our President

Dr. Samuel S Patterson

## **DIFFERENTIAL DIAGNOSIS AND RECENT PULP FINDINGS**

Dr. Bertram L. Wolfsohn, *Session Chairman*

**9:00 A.M. - 10:00 A.M.**

### **The Enigma of the Periapical Radiolucency**

*Essayist:* William G. Shafer, D.D.S., M.S.

**Abstract:** The routine practice of the endodontist deals principally with infected dental pulps, many of which are associated with a periapical radiolucency representing either a periapical granuloma or apical periodontal cyst. Obviously, there are many other lesions which bear no etiologic relationship to an infected pulp that also occur in the jaws. Unfortunately, many of these other diseases, some very serious, are frequently mistaken for dental infection by the unsuspecting and often harried practitioner. Considering the volume occupied by the roots of the 32 teeth and the volume of the medullary bone of the maxilla and mandible, it is actually difficult for a small lesion of any type to occupy a position within the jaws which is not in anatomic relationship to or continuity with one or more tooth roots. A variety of different pathologic lesions will be illustrated, many of which have represented errors in diagnosis or judgment, all of which have appeared radiographically as a periapical radiolucency simulating dental infection. It is hoped that this will emphasize the importance of careful evaluation of every radiolucent lesion of bone without being too impetuous in making a presumptive clinical diagnosis.

FRIDAY, APRIL 18th

*Biographical Sketch:*

Dr. Shafer is a Diplomat of the American Board of Oral Pathology and has served as Secretary-Treasurer and President. He is a Past-President of the American Academy of Oral Pathology. He is a Fellow or member of several other scientific organizations, the author of a "Textbook of Oral Pathology", and has published over one hundred articles in various medical and dental journals.

Dr. Shafer received his B.S. from the University of Toledo, a D.D.S., from Ohio State University and an M.S. from the University of Rochester. He is Professor and Chairman, Department of Oral Pathology at Indiana University School of Dentistry, Consultant in Oral Pathology for the Veterans Administration in Indianapolis and Consultant to the Surgeon General of the United States Air Force.

10:00 A.M. - 11:00 A.M.

**Diagnostic Possibilities Common to the Endodontist  
and Otolaryngologist**

*Essayist:* Richard Kurtz, M.D.

**Abstract:** Otolaryngology and endodontia, because of their common interests involving the oral cavity and to a greater extent the head and neck, present certain peculiar diagnostic possibilities that cannot be limited to any one specialty.

The paper points out certain symptoms, historical occurrences and findings that the endodontist might consider when trying to ascertain the patient's diagnosis. In accomplishing the above, a number of specific differential diagnostic possibilities must be considered.

Common everyday diseases such as acute purulent sinusitis, temporomandibular joint disturbances, and otitis media, along with more bizarre problems such as oral pemphigus, neoplasms of the maxilla and others, are considered.

Some easily accomplished office examination techniques that require no unusual equipment are described and their importance alluded to.

Finally, the paper stresses the necessity of regarding the patient as a whole rather than specific isolated anatomic parts that can only lead to misdiagnosis and subsequent mismanagement.

*Biographical Sketch:*

Dr. Kurtz is a Fellow in American Academy of Ophthalmology and Otolaryngology. He is certified by the American Board of Otolaryngology and is in private practice in Chicago, Illinois.

11:00 A.M. - 12:00 Noon

**Should Steroids be Considered in Pulp Therapeutics?**

*Essayist:* Harold R. Stanley, D.D.S., M.S.

**Abstract:** Because of the controversy and confusion existing today as to the use of steroids in pulp therapeutics, the "pros" and "cons" for their use will be presented. The fundamentals of pharmacology and therapeutics regarding drug purpose, nature and site of drug action, dose size and metabolism need to be emphasized. Pulp tissue is not that different from other connective tissues of the body and should be expected to respond similarly regarding therapeutics.

*Biographical Sketch:*

Dr. Stanley is Professor and Chairman, Division of Oral Pathology at the College of Dentistry, University of Florida. Until October 1968, he was the Clinical Director and Acting Chief of the Oral Medicine and Surgery Branch, National Institute of Dental Research, Bethesda, Maryland. He is a Diplomat of the American Board of Oral Pathology and is the immediate Past President of the American Academy of Oral Pathology. He received his D.D.S. degree from the University of Maryland in 1948 and his M.S. in Pathology from Georgetown University. In 1960 he was awarded an Honorary Professorship at the School of Dentistry, Universidad de San Carlos, Guatemala and received the Gorgas Odontological Society Award in 1962 for outstanding achievement in dentistry. Recently on the occasion of his U.S.P.H.S. retirement he was made an Honorary Staff Member of the U. S. Naval Dental School, Bethesda, Maryland.

# *Luncheon with Learning*

FRIDAY, APRIL 18th

12:00 - 2:00 P.M.

Gold Room

Dr. Herbert Schilder, *Session Chairman*

1. Dr. Clifford Ames, Vancouver, B. C., Canada  
*"Combined Endodontic-Periodontic Lesions"*
2. Dr. Orren A. Bolt, Grand Rapids, Michigan  
*"Infection? — Or Foreign Protein Rejection?"*
3. Dr. R. Pierre Dow, Vancouver, B. C., Canada  
*"Pain and Psycholinguistics"*
4. Alfred L. Frank, Los Angeles, California  
*"The Endodontic Implant"*
5. Jacob B. Freedland, Charlotte, North Carolina  
*"Intentional Replantation"*
6. Dudley H. Glick, Beverly Hills, California  
*"Endodontic failures: Causes, Determination & Correction"*
7. Melvin Goldman, Worcester, Massachusetts  
*"Endodontic Surgery"*
8. Leo Grudin, Beverly Hills, California  
*"Gutta Percha: The Ideal Filling Material"*
9. Morton Guttenberg, Rochester, New York  
*"A Simplified Nonreverting Bleaching Procedure"*
10. George C. Hare, Toronto, Ontario, Canada  
*"The Business Administration of a Referral Practice in Endodontics"*
11. J. Henry Kaiser, Columbus, Ohio  
*"Closure of Wide Apices of Pulpless Teeth Biochemically"*
12. Joseph M. Leavitt, New York, New York  
*Steps Towards Establishing a Partnership Practice in Endodontics"*
13. Harold J. Levin, Lynn, Massachusetts  
*"Three-Dimensional Filling of the Root Canal with Warm Gutta Percha"*
14. Richard M. Madden, Iowa City, Iowa  
*"Biophysical Aspects of the Dental Operatory"*



15. F. James Marshall, Columbus, Ohio  
*"Treating Endodontic Toothaches"*
16. Robert J. Matusow, West Action, Massachusetts  
*"Endodontic Considerations in Traumatically Injured Teeth"*
17. Harold A. Maxmen, Southfield, Michigan  
*"Unpublished Aids to Vexing Problems in Endodontics"*
18. Seymour Melnick, Hartford, Connecticut  
*"Emergency Treatment of Pain in Endodontic Practice"*
19. Andrew E. Michanowicz, Pittsburgh, Pennsylvania  
*"Root Fractures"*
20. John P. Michanowicz, Pittsburgh, Pennsylvania  
*"Treatment of Fractured Anterior Teeth"*
21. Richard M. Moodnik, Hempstead, New York  
*"Is it Necessary To Fill Lateral Canals."*
22. Thomas P. Mullaney, Lexington, Kentucky  
*"Simplified Diagnosis and Treatment of Pulpal and Periapical Disease"*
23. Nguyen T. Nguyen, San Francisco, California  
*"Traumatic Hemorrhagic Cysts — Problems and Management"*
24. Edwin B. Nutting, San Diego, California  
*"Save the Roots and You Save the Bone"*
25. Seymour Oliet, Philadelphia, Pennsylvania  
*"Specialty Practice Administration"*
26. Leonard N. Parris, Philadelphia, Pennsylvania  
*"Pulpal Anesthesia"*
27. Ignatius N. Quartararo, Garden City, New York  
*"Managing the Nonvital Tooth"*
28. Adrian J. Sampeck, Dallas, Texas  
*"Strengthening Fractured Roots"*
29. Samuel Seltzer, Philadelphia, Pennsylvania  
*"Radicular Cystogenesis"*
30. Robert J. Shankle, Chapel Hill, North Carolina  
*"Closing Incompletely Formed Apices Using Calcium Hydroxide"*
31. James H. Sherard, Jr., Atlanta, Georgia  
*"Moral and Legal Responsibility When Testifying as an Expert Witness"*
32. Milton Siskin, Memphis, Tennessee  
*"Interceptive Endodontics"*

FRIDAY, APRIL 18th

33. Walter Soltanoff, Montclair, New Jersey  
*"Clinical and Histopathologic Classifications of Pulpal Disease and Their Usefulness in Diagnosis"*
34. George C. Stewart, Philadelphia, Pennsylvania  
*"Let us Discuss Your Endodontic Problems"*
35. Warren T. Wakai, Honolulu, Hawaii  
*"X-Ray Interpretation in Endodontics"*
36. Bertram L. Wolfsohn, San Francisco, California  
*"Contemporary Refinements in the Diagnosis of Facial and Dental Pain"*
37. Edwin C. Van Valey, New York, New York  
*"Use of Snap Fasteners (Gerber) on Endodontically Treated Roots for Full Denture or Removable Bridge Stabilization"*

**FRIDAY, APRIL 18th**

**2:00 P.M. - 5:00 P.M.**

**Endodontic Treatment Considerations**

Dr. Charles A. Scott, Jr., *Session Chairman*

**2:00 P.M. - 3:00 P.M.**

**The Latest Evidence on the Psychology of Pain**

*Essayist:* Eugene E. Levitt, Ph.D.

**Abstract:** The title summarizes this presentation as it is based on data which have been recently obtained and were undergoing computer analysis at the time this program went to press.

*Biographical Sketch:*

Dr. Levitt received his B.S. from Brooklyn College and his Ph.D. from Columbia University in 1952. He is a Fellow of American Psychological Association, member or fellow of several other scientific organizations, Diplomate in Clinical Psychology, American Board of Examiners in Professional Psychology, Diplomate in Experimental Hypnosis, American Board of Examiners in Psychological Hypnosis. His publications include ninety-four professional and scientific articles, five books and fourteen reviews. He is Consultant to numerous organizations.

Dr. Levitt is Chief, Section of Psychology, and Professor of Clinical Psychology at Indiana University Medical Center.

**3:00 P.M. - 4:00 P.M.**

**Drug Therapy in Surgical Endodontics**

*Essayist:* Daniel M. Laskin, D.D.S., M.S.

**Abstract:** The dentist is constantly bombarded with literature extolling the benefits of new drugs appearing on the market. To avail himself of the best that is offered, he must be able to critically evaluate these agents. With this thought in mind, a rational approach to the problem of drug selection will be presented, emphasizing particularly those used in surgical endodontics such as sedatives, analgesics, antibiotics, and anti-edema agents.

*Biographical Sketch:*

Dr. Laskin received his D.D.S. degree from Indiana University and his Masters of Science degree from the University of Illinois. He is Professor and Associate Head of the Department of Oral and Maxillofacial Surgery in the College of Dentistry, Clinical Professor of Surgery in the College of Medicine, and Director of the Temporomandibular Joint Research Center at the University of Illinois

**FRIDAY, APRIL 18th**

Professional Colleges. He is also Chairman of the Department of Oral Surgery, Cook County Hospital.

Dr. Laskin is a Diplomat of the American Board of Oral Surgery and serves on its advisory committee, a member of the American Society of Oral Surgeons and Editor of the ASOS NEWSLETTER. He is also a member of Omicron Kappa Upsilon, Sigma Xi and a Fellow of the American College of Dentists. He has made over 80 contributions to the literature in Oral Surgery and in Dental Research, including a recent book on "The Management of Oral Emergencies."

**4:00 P.M. - 5:00 P.M.**

### **Cleaning and Shaping of Root Canals**

*Essayist:* Herbert Schilder, D.D.S.

**Abstract:** A cavity concept will be presented in which the entire root canal system and its contents are considered as black viewed coronal carious lesions. Basic principles govern the construction of access openings, internal preparation of the pulp chamber, and shaping of the root canals. Procedures will be presented to insure the complete cleaning of all pulp tissues and organic debris and the preparation of the root canals to optimally receive a dense three-dimensional obturation. Shaping procedures are unique for every tooth to be treated and must relate directly to the filling material to be employed. Guided by the basic principles, each canal is individually *shaped* rather than "instrumented" ritualistically with sequential reamers and files.

Cleaning and shaping are accomplished by the use of a combination of hand instruments, rotary instruments and chemical aids. The overriding requirements is to leave the root canal system truly *clean* and properly *shaped* with good visibility and working room for the dentist at every level of the canal, while still insuring the integrity of the natural apical foramen. A variety of cleaning and shaping procedures will be discussed for differently contoured canals and different filling materials but special emphasis will be placed upon a shaping procedure for use with warm gutta percha fillings.

#### *Biographical Sketch:*

Dr. Schilder received his D.D.S. from New York University in 1953 and has since been very active as a member and officer of numerous professional organizations. He has contributed to the endodontic literature, lectured extensively and presented Continuing Education courses at eight Universities and dental schools. He is Consultant, Council on Dental Education American Dental Association, 1967-; Chairman, Section on Endodontics American As-

sociation of Dental Schools, 1966-; President-Elect, Greater Boston Dental Society, 1968-69; member House of Delegates, Massachusetts Dental Society, 1964-; and Past Executive Board Member, American Association of Endodontics, 1964-67.

Dr. Schilder is Professor and Chairman, Department of Endodontics, School of Graduate Dentistry, Boston University. He limits his practice to endodontics.

**SATURDAY, APRIL 19, 1969**

**9:00 A.M. - 12:00 Noon**

**SCIENTIFIC SESSION**

Dr. George G. Stewart, *Session Chairman*

**9:00 A.M. - 9:30 A.M.**

**Endodontic Implants**

*Essayist:* Donald R. Morse, D.D.S.

**Abstract:** A brief history of techniques with definition and detailed description of endodontic implants will be presented. Indication and contraindications for implants, apical and lateral root endosseous implants, surgical and non-surgical approaches will be considered. Radiographs of cases will be shown and the cases discussed.

*Biographical Sketch:*

Dr. Morse received his D.D.S. and a Certificate in Endodontics from New York University, his M.A. in Microbiology and Genetics was obtained at Hofstra University. He is a member of several professional organizations, including the American Association of Endodontists and the Institute for Endosseous Implants. Dr. Morse is an Instructor in Microbiology at New York University Dental School and limits his practice to endodontics.

**9:30 A.M. - 10:30 A.M.**

**Surgical Principles in Endodontia**

*Essayist:* Robert B. Shira, D.D.S., F.A.C.D.

**Abstract:** Regardless of the type of surgical problems encountered certain cardinal principles must be followed to insure a successful operation. This presentation will stress the importance of such principles as: preoperative evaluation of the patient; adequate preoperative roentgenograms; premedication; adequate access; proper instruments; management of emergencies; and a careful postopera-

## SATURDAY, APRIL 19th

tive regime. Each of the cardinal principles will be illustrated with examples.

### *Biographical Sketch:*

Major General Shira is the Assistant Surgeon General and Chief of the Army Dental Corps. He is Past-President, American Society of Oral Surgeons and former member, Advisory Board to American Board of Oral Surgery. He is Chairman, Council on Dental Therapeutics, American Dental Association. He is Visiting Professor of Oral Surgery, School of Dentistry, College of Physicians and Surgeons University of the Pacific, San Francisco, and is a Lecturer in Oral Surgery at several other dental schools. General Shira is Associate Editor, Journal of Oral Surgery and Associate Editor for the Journal of Oral Surgery, Oral Medicine and Oral Pathology.

### 10:30 A.M. - 12:00 Noon

*Essayists:* E. James Best, D.D.S., and Robert Bragman, M.D.

**Abstract:** This illustrated presentation will be a discussion of the various aspects of performing endodontic treatment for the exceptional patient, either in the hospital or the dental office, utilizing general anesthetic agents. The first segment will be given by Dr. Bragman, who will discuss patient management relating to general anesthesia.

Dr. Best will present the techniques and variations in conventional treatment that should be incorporated in such a program. These lectures are based on the experiences of the clinicians as an operating team for over seven years.

### *Biographical Sketches:*

Dr. Best is Associate Professor, Department of Endodontics, Loyola University School of Dentistry, Chicago, Illinois. He is Chief of Dental Service St. Francis Hospital, Evanston, Illinois, and is a Diplomate of the American Board of Endodontics.

Dr. Bragman graduated from Chicago Medical College and following internship, as a resident in anesthesiology at University of Wisconsin. He was Attending Anesthesiologist, U. S. Army, and is currently Attending Anesthesiologist at St. Francis Hospital, Evanston, Illinois. He is a member of the American Medical Association, Illinois Medical Society, Chicago Medical Society and American Society of Anesthesiologists.

## THE EDGAR D. COOLIDGE MEMORIAL LECTURE

12:00 - 2:00 P.M.

Gold Room

"Back Up"

*Address by Dr. Maynard K. Hine*

Dr. Hine is Past-President of American Association of Dental Schools, American Dental Association, American Association of Endodontists and many other dental organizations. He is co-author of five books, including "Periodontia", with Dr. Coolidge. He was appointed Dean, School of Dentistry, Indiana University in 1945, and on November 1, 1968, was appointed Chancellor of Indiana University at Indianapolis.



**DR. EDGAR D. COOLIDGE**

Dr. Edgar David Coolidge, dentist and educator was born July 15, 1881, in Galesburg, Illinois, and died August 12, 1967. He was married to Laura M. Richelsen, July 21, 1909, and to Dorothy Lee Hammond, August 11, 1965. He received his D.D.S. from Chicago College of Dental Surgery in 1906; his B.S. from Lewis Institute in 1925; his M.S. from Northwestern University in 1930; his LL.d. from Loyola University in 1948; his Sc.D. in 1959, from Loyola University. Dr. Coolidge was an active member of many scientific organizations and was the recipient of numerous awards and honors for his accomplishments. He was the author of over five hundred articles and several textbooks. Dr. Coolidge had as his credo "WORK". Above his desk was the following paragraph in his handwriting, dated March 15, 1948:

*"Thank God every morning when you get up that you have something to do that day which must be done, whether you like it or not. Being forced to work and forced to do your best will breed in you temperance, self-control, diligence and strength of will, cheerfulness and a hundred virtues which the idle man can never know."*

**SATURDAY, APRIL 19th**

**2:00 P.M. - 4:00 P.M.**

**PROJECTED CLINICS AND TABLE CLINICS**

**PROJECTED CLINICS — CLINICAL**

**Plaza Room**

Dr. George B. Travers, *Session Chairman*

- 2:00 "Surgical Repair of Resorbed Root Structure"  
Bertram L. Wolfsohn, D.D.S.
- 2:15 "The Restoration of Endodontically Treated Anterior Teeth"  
Maxwell Saunders — Consultant Dental Surgeon, Birmingham  
Dental Hospital, Birmingham, England.
- 2:30 "O Malum, Quid In Infernis Nunc Facio"  
Edward E. Beveridge, D.D.S.
- 2:45 The Simplicity of Periapical Surgery  
James R. Jensen, D.D.S.
- 3:00 "Is a Reappraisal of Endodontic Access Necessary?"  
Bernard J. Zeldow, D.D.S.
- 3:15 "Professional Corporations"  
Jesse A. Mitchell, D.D.S.
- 3:30 "Surgical Flap Design"  
Raymond G. Luebke, D.D.S.

**PROJECTED CLINICS — RESEARCH**

**Florentine Room**

Dr. B. F. Gurney, *Session Chairman*

- 2:00 "Resistance of Nerve Fibers to Pulpal Necrosis"  
Thomas P. Mullaney, D.D.S., M.S.D.
- 2:20 "The Chilled Silver Cone as a Root Canal Filling Material"  
Lt. Cdr. Robert E. Cassidy, U.S.N.
- 2:40 "Steroid-Antibiotic Treatment in Endodontic Practice"  
Donald W. Schneider, D.D.S.
- 3:00 "Histologic and Clinical Examination of Permanent Anterior Teeth  
with Incompletely Formed Roots Following Conservative Endodon-  
tic Procedures"  
Andrew E. Michanowicz, D.D.S.



- 3:20 "Parachlorophenol; Why 25-35 Percent?"  
John W. Harrison, D.M.D.
- 3:40 "Evaluation of Root Canal Instruments"  
Solomon Sorin, D.D.S.\* — Seymour Oliet, D.D.S.  
\*Speaker

### TABLE CLINICS

#### Parkview, Columbian and Music Rooms

Dr. Lonnie C. Sibley, *Session Chairman*

1. "Endodontic Technique Review by Means of Motion Picture Cartridges"  
William Loran, D.D.S., University of the Pacific School of Dentistry
2. "The Radicular Amalgam"  
Gerard T. Grassi, D.D.S., Rochester, New York
3. "Three-Dimensional Root Canal Fillings"  
James D. Zidell, D.D.S., Los Angeles, California
4. "Pathosis of Dental Pulp: Etiology and Response"  
Robert Witek & John Wortel — Undergraduate Students,  
Loyola University, Chicago, Illinois
5. "Preparation of the Root Canal for a Post Crown"  
Arthur R. Friedman, D.D.S., Montclair, New Jersey
6. "Endodontic Rarities"  
Frank J. Gruchalla, D.D.S., Saint Louis, Missouri
7. "Root-End Amalgams"  
James S. Tate, D.D.S., Atlanta, Georgia
8. "A Unique Sealing of an Internal Resorptive Lesion of the Bifurcation"  
Manuel I. Weisman, D.D.S., Augusta, Georgia

### BUSINESS MEETING

#### Florentine Room

4:00 P.M. - 5:00 P.M.

### PRE-BANQUET RECEPTION

#### Belmont and Francis 1 Room

6:00 P.M. - 7:00 P.M.

## **INSTALLATION BANQUET-DANCE**

**SATURDAY, APRIL 19th**

**Gold Room — 7:00 P.M.**

featuring

**DAVID MALL AND HIS 10 PIECE ORCHESTRA**

Music During Dinner and Dancing until Midnight

Favors for the Ladies

**SUNDAY, APRIL 20th, 1969**

**8:30 A.M. - 12:00 Noon**

**SCIENTIFIC SESSION**

**Florentine Room**

Dr. Vincent B. Milas, *Session Chairman*

**8:30 A.M. - 9:15 A.M.**

**Post-Treatment Endodontic Pain**

*Essayist:* William H. Clem, D.D.S.

Abstract: A clinical study was designed to record increased pain experienced by patients following endodontic treatment appointments. Diagnosis and treatment procedures followed a standard format as closely as the clinical care of the patients would permit. Results based on 318 teeth indicate that moderate pain was experienced by 25% of the patients at some time following an endodontic treatment, that it followed 11% of the treatment appointments, and that it usually occurred after the first or second appointment. Mandibular molars were involved significantly more often than other teeth.

*Biographical Sketch:*

Dr. Clem is a practicing endodontist and Assistant Professor, University of Illinois. He received the D.D.S. degree from Northwestern University in 1956, and the M.S.D. from the University of Washington in 1965, where he also held the rank of Assistant Professor. As a Fellow of the National Institute of Dental Research, he published studies on antibacterial factors of saliva. He is Instructor, Northwestern University; Diplomate, American Board of Endodontics; Contributor to textbook, "Endodontics", by John I. Ingle.

**SUNDAY, APRIL 20th**

**9:15 A.M. - 10:15 A.M.**

**Endodontic — Restorative Interrelationships**

*Essayist:* Max Kornfeld, D.D.S.

**Abstract:** The presentation will be a consideration of (a) The importance of the endodontist to the restorative dentist, (b) Problems that the prosthodontist encounters after endodontic treatment, and (c) Methods and procedures of restoring the pulpless tooth for physiologic function and longevity.

*Biographical Sketch:*

Dr. Kornfeld is well known as an essayist and clinician, having appeared before dental societies in all sections of the United States. He is former Professor and Director of Crown and Bridge Prosthodontics, Saint Louis University School of Dentistry and is presently Visiting Professor of Restorative Dentistry, Washington University, School of Dentistry, Saint Louis, Missouri. He is Past-President of the Greater Saint Louis Dental Society and Missouri State Dental Association. He has received numerous awards and honors for his outstanding contributions to Dentistry. Dr. Kornfeld has a number of articles in dental journals and has contributed chapters to textbooks. Recently he has written a two-volume textbook entitled "Mouth Rehabilitation Clinical and Laboratory Procedures".

**10:15 A.M. - 11:15 A.M.**

**Current Status of Adhesive Dental Materials and Films**

*Essayist:* Ralph W. Phillips, M.S., D.Sc.

**Abstract:** The fundamental problems associated with adhesion of systems to oral structures will be discussed. This includes the effect of surface energy, roughness, debris and water. The various avenues of research which are being pursued, including marine adhesives, and newer formulations which are being presented to dentistry will be evaluated.

*Biographical Sketch:*

Dr. Phillips is Research Professor of Dental Materials, Indiana University School of Dentistry. Only thirty other professors in the history of Indiana University have ever been promoted to this distinguished professor rank. He is an Honorary Member of the American Dental Association and immediate Past-President of the International Association for Dental Research. His publications include over one hundred forty scientific papers and several textbooks on dental materials. He has appeared on over five hundred dental society programs in the United States and foreign countries.

**SUNDAY, APRIL 20th**

**11:15 A.M. - 12:00 Noon**

**The Production of High Quality Transparencies and Prints of  
Dental Radiographs**

*Essayist:* Ben Seidler, D.D.S.

**Abstract:** Most clinicians avoid the photographic medium by showing individual dental radiographs in sequence. It is obviously a better teaching method to permit direct visual comparison by showing related films on a single slide. Prints intended for publication must be of exceptional quality to reproduce well. The basic steps for achieving professional results will be described.

*Biographical Sketch:*

Dr. Seidler is a Diplomate of the American Board of Endodontics and former Research Associate, New York University. He is a Fellow, American Association for Advancement of Science, has lectured before many dental societies and has written a number of articles on endodontics and other subjects.

## SCIENTIFIC EXHIBITS

### Buckingham and Lincoln Rooms

Dr. Allan B. Klein, *Chairman*

#### BOOTH

- 3 MOLAR ENDODONTIC SURGERY  
Dr. Adolph Bushell, Assistant Professor, Boston University
- 5 ENDODONTIC FAILURE BECAUSE OF PERIODONTAL  
NEGLECT  
Dr. H. F. Vande Voorde, Moline, Illinois
- 8 PHOTOGRAPHIC PRINTS OF ENDODONTIC  
RADIOGRAPHS  
Dr. Ben Seidler, New York, New York
- 12 THE USE OF SLIDE-TAPE AUDIO-VISUAL EQUIPMENT  
TO AUGMENT AN ENDODONTIC TEACHING  
PROGRAM  
Dr. Thomas P. Mullaney, University of Kentucky
- 15 DOUBLE CANALS IN SINGLE ROOTS (CLASSIFICA-  
TION OF MAJOR & ACCESSORY FORAMINA)  
Dr. David Green, Brooklyn, New York
- \*H Dr. Robert L. Ellison  
PREMEDICATION OF APPREHENSIVE ENDODONTIC  
PATIENT
- \*H EXAMPLES OF ENDODONTICS ON NAVAL  
PERSONNEL  
Dr. Raymond Francis Young, USN, Great Lakes, Illinois

\*Hallway

## COMMERCIAL EXHIBITS

### Buckingham and Lincoln Rooms

Dr. N. S. Dubrow, *Chairman*

#### BOOTH

- 1 & 2 UNION BROACH CO., INC.
- 4 PRECISION X-RAY CO
- 6 MYNOL DENTAL SPECIALTIES
- 7 PREMIER DENTAL PRODUCTS CO.
- 9 STAR DENTAL MANUFACTURING CO.
- 10 DALECO PRODUCTS, INC.  
*Subsidiary of Denticator, Inc.*
- 11 PULPDENT CORPORATION OF AMERICA
- 13 CHARLES B. SCHWED CO., INC.
- 14 KERR DENTAL MANUFACTURING CO.

**EXHIBITS**

**PICK-CONGRESS HOTEL**

**COMMERCIAL and  
SCIENTIFIC EXHIBITS**

**AMERICAN ASSN.  
ENDODONTISTS  
April 16-20, 1969**

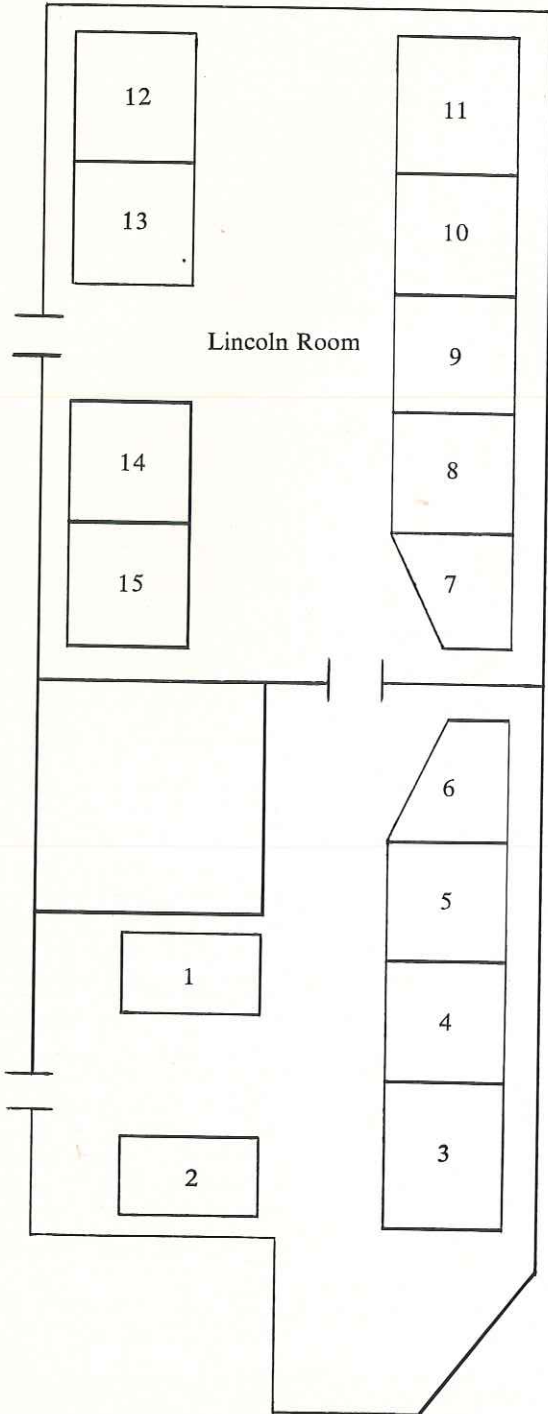

# AMERICAN ASSOCIATION OF ENDODONTISTS

## COMMITTEE APPOINTMENTS

1968-69

### Budget and Finance

Thomas Starshak, *Chairman*  
Luther H. Butler  
Dudley Glick  
Joseph Obst  
Charles Scott  
Robert Uchin

### Constitution

Charles Scott, *Chairman*  
Manuel Sir, *Co-Chairman*  
Bernard Grothaus  
Alvin Krakow  
Jesse Mitchell  
Thomas Mullaney  
John Sowle

### Editorial Board

I. B. Bender, *Chairman*  
Edward Beveridge  
Harry Blechman  
Louis Grossman  
Garth James  
Irving Naidorf  
Eugene Natkin  
Calvin Torneck

### Endodontics Insurance

Joseph Obst, *Chairman*  
James Guttuso  
Jack Landsburg  
Joseph Pollack  
Manuel Weisman  
Joseph Weisman  
Bertram Wolfsohn

### Trustees — E & M Foundation

J. B. Freedland, *Chairman*  
Robert Uchin, *Secretary*  
John Bucher  
Alfred Frank  
Harold Gerstein  
Andrew Michanowicz  
James Sherard, Jr.  
George Stewart  
William Walker, Sr.

### Ethics

Vincent Milas, *Chairman*  
Edward Beveridge  
Raymond Hayes  
Howard Martin  
Harold Maxmen  
Jesse Mitchell  
Marshall H. Smulson

### Honors and Awards

Maynard Hine, *Chairman*  
Julius Fox  
Charles E. Rudolph, Jr.  
Henry Schmidt  
James Sherard, Jr.  
Bertram Wolfsohn

### Subcommittee for Student Awards

Andrew Michanowicz, *Chairman*  
Luther Butler  
George Feldman  
Worth Gregory, Jr.  
Thomas Higginbotham  
Robert Shankle  
Adeeb Thomas

### Library

Donald Arens, *Chairman*  
Duane Compton, *Co-Chairman*  
James W. Diffley  
E. William Hicks  
Thomas Higginbotham  
Robert Krasny  
Thomas Mullaney  
Phillip Sherman, Jr.  
Joseph Rocco  
Franklin Wiene

### Literary

Michael Heuer, *Chairman*  
Louis Grossman, *Advisor*  
Howard Martin  
Andrew Michanowicz

**Long Range Planning**

Edwin Van Valey, *Chairman*  
Irwin Epstein  
Warren Hedman  
John Ingle  
Robert Uchin

**Membership**

Irving Naidorf, *Chairman*

**Necrology**

George Schugar, *Chairman*  
C. Don Gerdes  
Samuel Turkenkopf  
Robert Uchin

**Program Committee**

James W. Bynum, *Chairman*  
Charles Scott, *Co-Chairman*  
Robert A. Uchin, *Advisor*  
Bertram Wolfsohn  
Harold Gerstein  
George B. Travers  
*Projected Clinics - Clinical*  
Benamin E. Gurney  
*Projected Clinics - Research*  
Lonnie Sibley, *Table Clinics*  
Herbert Schilder  
*Luncheon With Learning*

**Sub-Committee for Commercial and Scientific Exhibits**

Harold Gerstein, *Chairman*  
Julian Kelly, *Co-Chairman*

**Section for Commercial Exhibits**

Nathan Dubrow, *Chairman*

**Section for Scientific Exhibits**

Marshall Smulson, *Chairman*

**Sub-section for Table Clinics**

John Sowle, *Chairman*

**Sub-section for Educational Exhibits**

Alan B. Klein, *Chairman*

**Sub-section for Projected Clinics**

Benjamin F. Gurney, *Chairman*

**Sub-Committee for Local Arrangements**

Harold Gerstein, *Chairman*  
Julian Kelly, *Co-Chairman*

**Banquet Section**

Maurice Alberti, *Chairman*

**Sub-section for Pre-meeting Reception**

Robert F. Kelly, *Chairman*  
Martin Ettinger, *Advisor*  
Maurice Alberti, *Ex Officio*  
Paul Ashkenas  
Myron Chubin  
Robert Fox  
Bernard Grothaus  
Marshall Smulson  
Franklin Weine  
Joseph Van Cura

**Sub-section for Luncheons Luncheon with Learning**

Vincent Schumacher, *Chairman*  
Hyman Baer, *Advisor*  
Maurice A. Alberti, *Ex Officio*  
Alan B. Klein

**Edgar D. Coolidge Memorial Luncheon**

Vincent Schumacher, *Chairman*  
Abel Moreinis, *Advisor*  
Maurice Alberti, *Ex Officio*  
Henry Kahn  
Alan B. Klein

**President's Banquet**

Maurice A. Alberti, *Chairman*  
Leo Botwinick, *Advisor*  
Herbert Rosenstein  
Louis Hirschman

**Student Members of A.A.E.**

Steven Kallman  
Benjamin L. Tyber  
Richard E. Walton  
Robert Zelikow



### **Section for Registration**

Charles Maurice, *Chairman*  
Robert Z. Fox  
Bernard J. Grothaus  
Robert F. Kelly  
William L. McDaniel  
John J. O'Malley  
Nijole A. Remeikis  
Harry R. Shepard  
Gordon L. Stastny  
Joseph E. Van Cura

### **Section for Ushers and Monitors**

Harold Epstein, *Chairman*  
Arthur Arshawsky  
Morton Bernstein  
Leo Botwinick  
Gerald Dietz  
Anthony Dietz  
Melvyn Eder  
Irving Epstein  
Arnold Feldman  
Marvin Forman  
Maurice Friedman  
Phillip Norris  
James Pearce  
H. M. Rappaport  
Manuel Weissman

### **Section for Projection and Sound**

George Zurkow  
Henry Kahn, *Chairman*  
Myron Chubin  
Harry Greene  
Chris Vikari

### **Section for Hosts**

Robert Z. Fox, *Chairman*  
Robert F. Kelly  
Paul Ashkenaz  
Myron Chubin  
Marshall Smulson  
Joseph E. Van Cura  
Bernard J. Grothaus  
Franklin Weine

### **Publicity**

William H. Clem, *Chairman*

### **Ladies Program Committee**

Mrs. Vincent Milas, *Chairman*  
Mrs. Harold Gerstein  
Mrs. Samuel S Patterson  
Mrs. Louis Siegel  
Mrs. Thomas C. Starshak

### **Nominating**

Henry Schmidt, *Chairman*  
John Ingle  
Edwin Van Valey

### **Publications**

Seymour Oliet, *Chairman*  
Clifford Ames  
Daniel Arefian  
Walter Colquitt  
Edward Deeb  
Stuart Fountain  
Bernard Grothaus  
George Israel  
Edwin Nutting  
Adeeb Thomas  
Robert Uchin

### **Site Selection**

Raymond Luebke, *Chairman*  
John Dowson  
James Guttuso  
James Jensen  
L. A. Lucas  
Nguyen Nguyen  
Herbert Schilder

### **Study Club**

Leonard Evanson, *Chairman*  
F. Paul Beall, *Advisor*  
F. Bruce Burns  
*Canadian Liaison*  
*Presidents of Study Clubs*

**Subcommittee to Evaluate  
Committees**

Herbert Schilder, *Chairman*

Robert Uchin

*Ex-Officio Member*

George Israel

Joseph Leavitt

Joseph Obst

**Research**

Bertram Wolfsohn, *Chairman*

Neal Chilton

Michael Heuer

Peter Kapsimalis

Theodore Lundy

Herbert Schilder

Samuel Seltzer

**NOTES**

