



**ENDODONTICS '85:
THE CHALLENGE OF CHANGE**



TABLE OF CONTENTS

	Page
AAE Officers & Board of Directors.....	3
AAE Endowment & Memorial Foundation Trustees.....	20
ABE Board of Directors.....	20
Annual Session Committee.....	4
Award Recipients.....	21
Committee Meetings (AAE).....	17
Condensed Program.....	22
Floor Plan.....	18
General Information.....	5
Index of Exhibitors.....	19
Participants' Index.....	23
Past Presidents.....	20
Program	
Wednesday.....	6
Thursday AM.....	7
Thursday PM.....	8
Friday AM.....	10
Friday PM.....	12
Saturday AM.....	13
Saturday PM.....	16
Sunday AM.....	16
Study Clubs/Alumni Groups.....	17
AAE Auxiliary.....	21



**American Association of Endodontists
42nd Annual Session
April 24-28, 1985
San Diego, California**



PRESIDENT'S MESSAGE

It is indeed a pleasure to welcome you to the 42nd Annual Session of the American Association of Endodontists. San Diego provides us a most beautiful and relaxed atmosphere in which to address many diverse but relevant subjects as well as to renew friendships and enjoy numerous special activities planned for us over the next four days.

Our theme "Endodontics '85: The Challenge of Change" focuses on many of the issues identified by our membership and the AAE as having an impact on the future of endodontics. Dr. Stephen Cohen, General Chairman, and Dr. Terrence Hayes, Program Chairman, and their committees have orchestrated a program that should satisfy our professional appetites while at the same time combining a myriad of special events and activities that will provide us all with a meaningful and memorable visit in sunny California. Dr. Stephen Arlin and his Local Arrangements Committee have made sure that our stay here will abound with unmatched hospitality and enjoyable activities unique to San Diego.

I extend a special welcome to our many international members and guests who have come not only to participate in the annual session, but to represent their countries in the birth of an International Federation of Endodontic Associations.

Aside from the traditional meeting format which this year includes an impressive list of clinical, scientific, and practice management presentations, some very special events will take place. The creativity of our Annual Session Committee and the talents of Dr. Richard Burns will be in evidence with the opening Welcome/Fellowship Reception at Sea World on Wednesday and climaxed by an entertainment filled Saturday night "Black and White Ball".

Important organizational activities scheduled include a very important General Assembly Meeting involving discussions and decisions having a significant impact on the future direction of the AAE. Don't miss it!

Great meetings, such as this promises to be, represent countless hours of volunteer effort by our members and dedicated attention to every detail by our professional staff. To Stephen Cohen, Terrence Hayes, Stephen Arlin and their committees who have created such a well-balanced program and made us feel so comfortable in San Diego — our hats are off to you. To Irma Kudo, our Executive Director extraordinaire, and her staff of Laura Cancilla, Sandra DiRocco, Letty Catrambone and Elizabeth Peralta, who have made the entire experience so easy with their professional approach and concern for our enjoyment, we applaud you. And to you, our members and guests, I personally wish each of you a most enjoyable and rewarding meeting.

Stephen F. Schwartz, DDS, MS
President

AMERICAN ASSOCIATION OF ENDODONTISTS

EXECUTIVE COMMITTEE



Stephen F. Schwartz
President



Herbert Schilder
President-elect



Michael A. Heuer
Vice-president



Joseph D. Maggio
Secretary



Charles J. Cunningham
Treasurer



Steve Montgomery
Acting Editor



Donald E. Arens
Immed. Past president



Irma S. Kudo
Executive Director

BOARD OF DIRECTORS

1985

Leif K. Bakland
Carl L. Tinkelman

1986

Nguyen T. Nguyen
Milton Siskin
Herbert F. Spasser

1987

Myron Chubin
M. Lamar Hicks
Eric J. Hovland





WELCOME

The goal of your Annual Session Committee has been to assemble a program equal to the scenic, climatic and cultural pleasures of our host city, San Diego.

Toward this end we have assembled a varied and exciting program to stimulate you in the way you practice endodontics. There are also presentations to enrich your personal life as well as sports activities, wine-tasting and social events.

The number of technical exhibitors is increasing annually. Support them as they support our meeting. When possible, order your supplies and equipment from them at this meeting.

Personal and AAE thanks must go to the Local Arrangements Committee headed by Dr. Stephen Arlin and to the Program Committee. Thanks also to President Stephen F. Schwartz and General Chairman Stephen Cohen for their guidance, and to Mrs. Irma Kudo and the Central Office staff who have been superb with their assistance and attention to detail. A special thanks to the families of all involved for their patience and support.

Enjoy San Diego and our 42nd AAE meeting.

Terrence Hayes

Terrence W. Hayes, DDS
Program Chairman

ANNUAL SESSION COMMITTEE



Stephen Cohen
General Chairman



Terrence W. Hayes
Program Chairman

Program

Continuing Education	James L. Gutmann
Roundtable Seminars.....	Joe H. Camp
Printed Program.....	Irma S. Kudo
Research Seminars.....	Melvin Goldman
Table Clinics/Poster Clinics.....	Mark E. Levine

General Arrangements

Local Committee Chairman	Stephen R. Arlin
Audio-Visual	Edward M. Osetek William Masheter
Banquets & Meals.....	Richard C. Burns
Hospitality.....	Paul E. Zeigler
Monitors.....	Leif K. Bakland
Registration	Robert Bravin Maurice Cutler Dominic Niccoli
Signs	Eugene C. Hanson
Sports	Ned W. Jerge Gary B. Carr
Technical Exhibits	Letty Catrambone
AAE Auxiliary Chairperson.....	Gina Schmidt



The statements and opinions expressed at the annual session are solely those of the individual speakers. Those statements and opinions do not reflect any endorsement by the American Association of Endodontists.



GENERAL INFORMATION

The Town & Country Hotel is the headquarters hotel for the 42nd Annual Session.

AAE Headquarters - Santa Fe Room

The headquarters office will be staffed by members of the Central Office — Laura Cancilla, Letty Catrambone, Sandy DiRocco, Elizabeth Peralta — and by members of the Annual Session Committee. Office hours are 8 am - 6 pm Wednesday through Friday and 8 am - Noon on Saturday.

General Registration - Mission Foyer

Wednesday, April 24: 11 am - 8 pm

Thursday, April 25: 8 am - 6 pm

Friday, April 26: 8 am - 5 pm

AAE MEMBERS (after March 12)

\$175 (includes all scientific sessions, Welcome/Fellowship Reception, one full breakfast (Thursday), two luncheons (Friday and Saturday), three continental breakfasts, and one ticket to the Saturday evening dinner dance)

AAE ASSOCIATE MEMBERS

\$225 (same as above)

AAE STUDENT MEMBERS

\$ 75 (all scientific sessions, Welcome/Fellowship Reception)

NON-MEMBER PROFESSIONALS

\$200 (all scientific sessions)

NON-MEMBER STUDENTS

\$ 75 (all scientific sessions)

DENTAL AUXILIARIES

\$ 55 (all scientific sessions)

SPOUSES

\$ 55 (Welcome/Fellowship Reception, use of hospitality suite)

Exhibits - Presidio Room

Because exhibitors help to defray some of the cost of the annual session, we encourage you to stop by the exhibits and place your order in San Diego. Complimentary coffee service will also be provided on Thursday and Friday, 10:30 am-12 Noon and at 2:30 pm-4:00 pm in the exhibit area.

Exhibit hours are:

Thursday, April 25: 10 am - 6 pm

Friday, April 26: 8 am - 5 pm

Saturday, April 27: 8 am - Noon

Roundtable Seminars/Computer Workshops

Tickets reserved in advance are included in each individual's registration packet. To register for an open Roundtable Seminar or Computer Workshop, or to exchange tickets, inquire at the special desk located in the AAE registration area.

Cassette Tape Recordings

American Audio Association will record many of the sessions presented. The cassette tapes are available for purchase at the American Audio booth located in the registration area.

Speaker Ready Room

Program participants are urged to review their audio-visual material in the Speaker Ready Room (Helix Room) prior to their presentation to avoid possible problems that may occur.

Saturday Dinner Dance

Your table selection for the 'Black and White Ball', our Saturday dinner dance, must be made as soon as possible before 5 pm on Thursday by exchanging your voucher for a banquet ticket at the AAE registration desk. If you wish to have a group seating, you must present a voucher for each person in your group in order to reserve the space. No exceptions will be made.

Continuing Education Credit

American Dental Association — Individuals who participate in the ADA registry program will receive continuing education credits as follows:

- 5 credits for general attendance at the annual session. This includes attendance at table clinics and/or exhibits.
- Hour-for-hour credit for attendance at a scientific presentation of at least one hour's duration. This must be of a scientific or a clinical nature.

California Board of Dental Examiners — Information not available at press time.

Academy of General Dentistry — All course forms may be validated at the AAE headquarters office.



Smoking

For the comfort of others, no smoking is permitted in the meeting rooms.

PROGRAM



MONDAY, APRIL 22

9:00 am- **ABE BOARD OF DIRECTORS MEETING**
6:00 pm El Camino Room



TUESDAY, APRIL 23

9:00 am- **E&M FOUNDATION TRUSTEES MEETING**
5:00 pm Council Room

8:00 am- **ABE ORAL EXAMS**
5:00 pm De Anza, Mesa, Adobe & El Camino Rooms



WEDNESDAY, APRIL 24

9:00 am- **AAE BOARD OF DIRECTORS MEETING**
5:00 pm Council Room

8:00 am- **ABE ORAL EXAMS**
5:00 pm De Anza, Mesa, Adobe & El Camino Rooms

11:00 am- **REGISTRATION**
8:00 pm- Mission Foyer

CONTINUING EDUCATION COURSE

San Diego Room (Pre-registration required.)

Comprehensive diagnosis and management
of pain in endodontic practice

*Moderators: JAMES L. GUTMANN, DDS, Dallas
EDWARD M. OSETEK, DDS, MA,
Chicago*

8:30 am Welcome

8:45 am Pathways of pain mechanisms in the head and neck
PIERRE R. DOW, DDS, MSC, University of British
Columbia

10:15 am Coffee break — Golden West Room

10:30 am Non-dental pain: Clinical examination and
differential diagnosis
SAMUEL SELTZER, DDS, Temple University

12 Noon Luncheon — Golden West Room

1:00 pm Neurological considerations in the diagnosis and
management of head and neck pain
JOSEPH TOGLIA, MD, Temple University

2:30 pm Coffee break — Golden West Room

2:45 pm Chronic pain and its serious complications for both
the patient and the practitioner
JOHN J. BONICA, MD, University of Washington

4:15 pm Discussion

6:00 pm- **EVENING AT SEA WORLD**
9:30 pm (By ticket only. Buses depart every 30 minutes
beginning at 6 pm)



SMOKING

For the comfort of others, no smoking is permitted in the
meeting rooms.



**BADGES MUST BE WORN AT ALL OFFICIAL AAE
FUNCTIONS**



IMPORTANT NOTICE

**Be sure to exchange your voucher by 5:00 pm
Thursday to reserve a seat for the Black & White Ball
dinner dance on Saturday. Your cooperation will be
appreciated as we cannot extend this deadline.**



THURSDAY MORNING, APRIL 25

8:00 am- **REGISTRATION**
6:00 pm Mission Foyer

8:00 am- **OPENING SESSION BREAKFAST**
8:45 am (By ticket only)
Golden West & California Rooms

KEYNOTE: STEPHEN F. SCHWARTZ, DDS, MS
"Winning at the Slowest Possible Speed"

10:00 am- **EXHIBITS**
6:00 pm Presidio Room

BUSINESS SESSIONS I and II

Town & Country Room
Moderator: JACK A. WEICHMAN, DDS, JD,
Pacific Palisades, CA

10:00 am- *The Verdict* — a courtroom drama on malpractice
5:00 pm in endodontics
Attorneys: EDWIN ZINMAN, DDS, JD and
ARTHUR CURLEY, JD, San Francisco

A simulated courtroom drama involving a patient, his dentist, their attorneys, a judge and jury. The drama will be moderated for your ease in understanding any complex legalities. As a spectator you will have the opportunity to compare your verdict to the jury's. An enlightening update on endodontics and the law.

SCIENTIFIC SESSION I

Padre & Sierra Rooms
Moderator: ROBERT J. ROSENBERG, DDS,
DScD, Greenbrae, CA

10:00 am- Head, neck, and TMJ pain that mimics endodontic
12 Noon pain
TERRY TANAKA, DDS, Chula Vista, CA

Among the many pain disorders that affect the head, neck and face are referred pains that mimic endodontic tooth pain and are the cause of numerous endodontic therapies and eventual extractions. The specialist's ability to differentiate referred facial pains from pain of endodontic origin must be based upon a rational medical-dental model of differential diagnosis. This model will be demonstrated along with its clinical implications in endodontics.

RESEARCH SEMINARS I

San Diego Room
Moderator: MELVIN GOLDMAN, DDS,
Worcester, MA

10:00 am Speed of canal preparation using different endodontic irrigants: A time-motion study
BRIAN A. MYKLEBY*, DDS;
KEITH V. KRELL, DDS, MS, MA, University of Iowa

10:15 am SEM comparison of ultrasonic vs. hand instrumentation of root canals
MARK C. BAKER*, DDS; S. H. ASHRAFI, PhD;
JOSEPH E. VANCURA, DDS;
NIJOLE A. REMEIKIS, DDS, University of Illinois

10:30 am Endosonic vs. hand instrumentation time
DAVID W. PEDICORD*, DDS;
MAHMOUD E. ELDEEB, BDS, MS;
HAROLD H. MESSER, MDSc, PhD,
University of Minnesota

10:45 am SEM study of ultrasonically energized files with and without flutes
VICTOR M. GARCIA*, DDS; S. H. ASHRAFI, PhD;
ROBERT ZELIKOW, DDS;
NIJOLE A. REMEIKIS, DDS, University of Illinois

11:00 am The effectiveness of intracanal medicaments on anaerobic organisms in endodontics
SIDNEY W. SIMMONDS*, DDS;
PAMELA PAPPAS, DMD; MELVIN GOLDMAN, DDS;
CHARLES HABIB, DMD, PhD, Tufts University

11:15 am Impact of thermal tests on the human pulp
BRUCE D. RICKOFF*, DDS;
HENRY O. TROWBRIDGE, DDS, PhD; ZVIFUSS, DMD;
I. B. BENDER, DDS, Albert Einstein Medical Center
and University of Pennsylvania

11:30 am The apical dentin plug in root canal preparation
STEVEN M. PATTERSON*, DDS, MSD;
SAMUEL S PATTERSON, DDS, MSD;
CARL W. NEWTON, DDS, MSD;
ABDEL KAFRAWY, BDS, MSD, Indiana University

11:45 am Comparing dentin chips, hydroxylapatite, and demineralized dentin as apical plugs
D. WYLIE BRANDELL*, DDS;
MAHMOUD TORABINEJAD, DMD, MSD;
LEIF K. BAKLAND, DDS, Loma Linda University

*PRESENTER

PROGRAM *(continued)*



THURSDAY AFTERNOON, APRIL 25

12 Noon-1:30 pm **LUNCHEON**
On your own

BUSINESS SESSION II Town & Country Room

1:30 pm-5:00 pm *The Verdict*
(Continued from morning session.)

COMPUTER WORKSHOP Friars Room (Limited attendance. Pre-registration required)

2:00 pm-5:00 pm GERALD C. DIETZ, DDS, MS, Birmingham, MI
This hands-on workshop will help you understand the automated endodontic office. Information necessary for making a wise choice of computers will be given and data processing equipment will be available to give you the opportunity to input data and to analyze computer generated reports. *(Computer equipment provided through the courtesy of Kelly Systems of Birmingham, MI)*

5:00 pm-6:00 pm **AADS Endodontic Section Meeting**
Padre & Sierra Rooms

SCIENTIFIC SESSION II Padre & Sierra Rooms *Moderator: BRUCE H. SEIDBERG, DDS, MScD, Syracuse, NY*

2:00 pm-5:00 pm The status of implants in an endodontic practice
LARRY G. LOOS, DDS, San Francisco
Dental implants have achieved a very poor reputation in the United States. Spurred by excellent clinical research in Sweden, predictably successful dental implants are appearing in the nineteen eighties. Dr. Loos will review implants in general and discuss several specific systems which have a certifiable history. All of these implants will affect total case treatment planning.



NEED A BREAK?

Visit the Technical Exhibits. Complimentary coffee service will be provided in the Exhibit Area (Presidio Room) on Thursday and Friday, 10:30 am-12 noon and 2:30 pm-4:00 pm.

1:30 pm-3:00 pm **ROUNDTABLE SEMINARS**
(Limited attendance. Pre-registration required)

- RT 1 Council Room**
Perio-endo lesions: a diagnostic dilemma
GARY R. HARTWELL, DDS, MS, Evans, GA
- RT 2 Chamber Room**
Geriatric endodontics
JERRY F. TAINTOR, DDS, MS, Sherman Oaks, CA
- RT 3 Cabinet Room**
Better buildups for endodontically treated teeth
ALAN G. SELBST, DMD, MS, Houston
- RT 4 Forum Room**
Restoration following endodontic treatment
GARY N. TAYLOR, DDS, MS, Maywood, IL and
KENNETH C. TRABERT, DDS, Santa Monica, CA
- RT 5 Senate Room**
Endodontic surgery utilizing I.M. and I.V. sedation
STEVEN A. HELD, DDS, State College, PA
- RT 6 Committee Room**
Oral infection: spread and localization
HEDLEY RAKUSIN, BDS, and
JOHN B. ROSS, DDS, Dallas

3:15 pm-4:45 pm **ROUNDTABLE SEMINARS**
(Limited attendance. Pre-registration required)

- RT 7 Council Room**
Endosonic endodontics
HOWARD MARTIN, DMD, Silver Spring, MD and
WALTER T. CUNNINGHAM, DDS, Annapolis, MD
- RT 8 Chamber Room**
Injectable gutta-percha — the endodontic revolution
JAY MARLIN, DMD, Worcester, MA
- RT 9 Cabinet Room**
A new dimension in root canal obturation
ANDREW E. MICHANOWICZ, DDS;
JOHN P. MICHANOWICZ, DDS;
MARIO CZONSTKOWSKY, DDS, MDS, Pittsburgh, PA
- RT 10 Forum Room**
Expeditious endodontics and promising
technique enhancements
JOHN T. McSPADDEN, DDS, Johnson City, TN
- RT 11 Senate Room**
Surgical endodontics
CLIFFORD J. RUDDLE, DDS, Santa Barbara, CA
- RT 12 Committee Room**
Antibiotics in endodontics
ANTHONY D. GOODMAN, DDS, MScD, Los Angeles



RESEARCH SEMINARS II

San Diego Room

Moderator: SEYMOUR OLIET, DDS,
Philadelphia

- 1:30 pm Electronic apex locators' reliability in gly-oxide®, ethanol and desiccated canals
JOHN N. KIRK*, DDS, MA;
RAYMOND L. WARNER, PhD;
JOHN R. LUDINGTON, JR., DDS, MSD;
JEFFREY HOOVER, DMD, MS, University of Texas;
GERALD F. KUTISH, PhD, University of Nebraska
- 1:45 pm Properties of an experimental endodontic sealer
GERALD N. GLICKMAN*, DDS, Baylor College of Dentistry; E. H. GREENER, PhD;
EDWARD M. OSETEK, DDS, MA, Northwestern University
- 2:00 pm Marginal leakage between temporary sealing materials and restorative materials
JAMES P. ORAHOOD*, DDS, MSD;
M. L. SWARTZ, MS; M. A. COCHRAN, DDS, MSD;
CARL W. NEWTON, DDS, MSD, Indiana University
- 2:15 pm Dye leakage in dentin bonded resins used as retrofilling materials
KIRK R. RYSKAMP*, DDS; LEIF K. BAKLAND, DDS;
MAHMOUD TORABINEJAD, DMD, MSD, Loma Linda University
- 2:30 pm Fluorescent demonstration of sealer penetration into dentinal tubules
MARIA A. RABBIO*, DMD; ROBERT WHITE, DMD;
MELVIN GOLDMAN, DDS; JOHN BELL, DDS;
ALLAN GREENBERG, DMD; P. S. LIN, PhD,
Tufts University and New England Medical Center
- 2:45 pm Radioimmunoassay of prostaglandins in painful and asymptomatic human dental pulps
JAY S. COHEN*, DMD, MS; RICHARD FERTEL, PhD;
ALFRED W. READER, DDS, MS;
F. MICHAEL BECK, DDS, MA;
WILLIAM J. MEYERS, DMD, MED,
Ohio State University
- 3:00 pm The detection of immune complexes in untreated periapical lesions
SUNIL R. SRINIVASAN*, BDS;
RUSSELL J. NISENGARD, DDS, PhD;
MING SHIH LEVINE, DDS, MS,
State University of New York at Buffalo
- 3:15 pm Identification of *bacteroides* SP. in human dental pulp by immunofluorescence microscopy
EUGENE A. PANTERA, JR.*, DDS;
JOSEPH J. ZAMBON, DDS, PhD;
MING SHIH LEVINE, DDS, MS,
State University of New York at Buffalo
- 3:30 pm The electric pulp tester: Measurement of analgesia in human teeth
LEE J. DREVEN*, DMD, MS;
ALFRED W. READER, DDS, MS;
F. MICHAEL BECK, DDS, MA;
WILLIAM J. MEYERS, DMD, MED;
JOEL WEAVER, DDS, PhD, Ohio State University
- 3:45 pm Volumes and concentrations of lidocaine in human IAN block
DAVID L. VREELAND*, DDS, MS;
ALFRED W. READER, DDS, MS;
F. MICHAEL BECK, DDS, MA;
WILLIAM J. MEYERS, DMD, MED,
Ohio State University
- 4:00 pm The periodontal ligament injection: A comparison of various solutions
JOHN R. SCHLEDER*, DDS, MS;
ALFRED W. READER, DDS, MS;
F. MICHAEL BECK, DDS, MA;
WILLIAM J. MEYERS, DMD, MED,
Ohio State University
- 4:15 pm The effects of Nd-YAG laser irradiation on dyed canal wall dentin
DOUGLAS N. DEDERICH*, DDS;
KENNETH L. ZAKARIASEN, DDS, MS, PhD;
JOHN TULIP, PhD, University of Alberta
- 4:30 pm Osseous reactions to three hemostatic agents
JOSE LUIS E. IBARROLA*, CD, MS;
J. E. BJORENSEN, PhD; B. P. AUSTIN, PhD;
HAROLD GERSTEIN, DDS, Marquette University
- 4:45 pm Prophylactic penicillin usage in cases of asymptomatic periapical pathosis
ESTUARDO C. MATA*, DDS; LARRY Z. KOZEN, BDS;
DONALD R. MORSE, DDS;
IRVING H. SINAI, DDS, Temple University

*PRESENTER



PROGRAM *(continued)*



FRIDAY MORNING, APRIL 26

6:00 am **FUN RUN**
(Pre-registration required) Buses depart from
Convention Center Entrance

8:00 am- **REGISTRATION**
5:00 pm Mission Foyer

8:00 am- **CONTINENTAL BREAKFAST**
8:45 am (By ticket only)
Golden West & California Rooms

8:00 am- **EXHIBITS**
5:00 pm Presidio Room

BUSINESS SESSION III

Town & Country Room
Moderator: *RICHARD H. YAMANAKA, DDS,*
Napa, CA

9:00 am- 12 Noon The emergency within: stress inside and outside of
endodontics
(For members and spouses)
EDMOND C. HALLBERG, MA, EdO and
KAYLENE HALLBERG, MA, Sierra Madre, CA
This presentation will look at stress and its effects on
the dentist and on his/her spouse and practice.
Special dental stressors will be examined and, using
the stress schedule developed by the Hallbergs, the
stress level of individual participants will also be
examined. Learn the S.T.E.P. U.P. method of
stress reduction.

SCIENTIFIC SESSION III

Padre & Sierra Rooms
Moderator: *ROGER T. CZARNECKI, DDS,*
Buffalo, NY

9:00 am- 12 Noon Uncommon problems in your office
JOHN W. BEIERLE, PhD, Los Angeles
This presentation will discuss the current status of
AIDS as it is related to causative agents,
transmission, oral clinical findings, diagnosis and its
debilitating action. The section on herpes will
update the clinician on members of the herpes
group in regard to prevention of transmission in the
operatory. The status of herpes as a cancer inducing
agent will be discussed.

9:00 am- **ROUNDTABLE SEMINARS**
11:00 am (Limited attendance. Pre-registration required)

RT 13* Chamber Room
Injectable gutta-percha - the endodontic revolution
JAY MARLIN, DMD, Worcester, MA

RT 14* Council Room
Endosonic endodontics
HOWARD MARTIN, DMD, Silver Spring, MD and
WALTER T. CUNNINGHAM, DDS, Annapolis, MD

RT 15* Cabinet Room
A new dimension in root canal obturation
ANDREW E. MICHANOWICZ, DDS;
JOHN P. MICHANOWICZ, DDS;
MARIO CZONSTKOWSKY, DDS, MDS,
Pittsburgh, PA

RT 16* Forum Room
Expeditious endodontics and promising
technique enhancements
JOHN T. McSPADDEN, DDS, Johnson City, TN

RT 17 Senate Room
"Bacteria busters" — a clinical update on efficient
office organization & instrument sterilization
ROBERT E. AVERBACH, DDS, Denver, CO

RT 18 Committee Room
Practical periodontics for the practicing endodontist
PAUL L. MICHAELIDES, DDS, MScD, Fresno, CA

*Repeat of Thursday's Roundtable

9:00 am- **COMPUTER WORKSHOP**
12 Noon Friars Room
(Limited attendance. Pre-registration required)
GERALD C. DIETZ, DDS, MS, Birmingham, MI
(Repeat of the workshop presented on Thursday)



RESEARCH SEMINARS III

San Diego Room

Moderator: SAMUEL SELTZER, DDS,
Philadelphia

- 9:00 am Resistance to fracture of restored endodontically-treated premolars
MARTIN TROPE*, BDS;
DAVID MALTZ, DMD, MScEd;
I. LANGER, DMD; LEIF TRONSTAD, DMD, PhD,
University of Pennsylvania
- 9:15 am A comparison between xeroradiography and conventional radiography in the diagnosis of endodontic lesions
RAHMAT A. BARKHORDAR*, DMD;
RONALD J. NICHOLSON, DDS,
University of California at San Francisco
- 9:30 am Detection of developing periapical lesions using digital subtraction radiography
JOSEPH H. INTROCASO*, DMD;
ELIZEU A. PASCON, DDS, MS;
J. E. GRASSO, DDS, MS;
KAARE LANGELAND, DDS, PhD,
University of Connecticut
- 9:45 am A method for the development of predictable periapical lesions
ELIZEU A. PASCON*, DDS, MS;
JOSEPH H. INTROCASO, DMD;
KAARE LANGELAND, DDS, PhD,
University of Connecticut
- 10:00 am An SEM survey of root canal debridement using three irrigants
J. CRAIG BAUMGARTNER*, DDS;
CARSON L. MADER, DMD, MSD,
Walter Reed Army Medical Center
- 10:15 am An SEM study of the extent of the odontoblastic process
MELVIN GOLDMAN*, DDS;
ROBERT R. WHITE, DMD, Tufts University
- 10:30 am Presence of osteoclast activating factor in human periapical lesions
RICHARD A. LUBEN*, PhD;
MAHMOUD TORABINEJAD, DMD, MSD,
Loma Linda University
- 10:45 am CO₂ and Nd-YAG laser fusion of dentin plugs in root canals
KENNETH L. ZAKARIASEN*, DDS, MS, PhD;
DOUGLAS N. DEDERICH, DDS;
JOHN TULIP, PhD, University of Alberta
- 11:00 am Etiologic factors leading to root canal procedure
GILBERT CYR*, DDS; LAURENCE ARVIS, DDS;
KAMRAN SAFAVI, DMD, MEd;
KAARE LANGELAND, DDS, PhD,
University of Connecticut
- 11:15 am Evaluation of antimicrobial potential of calcium hydroxide *in vivo* and *in vitro*
KAMRAN SAFAVI*, DMD, MEd;
WILLIAM E. DOWDEN, DDS;
KAARE LANGELAND, DDS, PhD,
University of Connecticut
- 11:30 am Evaluation of tissue reaction to endodontic materials
KAARE LANGELAND*, DDS, PhD;
ELIZEU A. PASCON, DDS, MS;
M. R. LEONARDO, DDS;
KAMRAN SAFAVI, DMD, MEd,
University of Connecticut
- 11:45 am The ferret as an animal model in endodontic research
G. REX HOLLAND, BDS, PhD,
University of Alberta

*PRESENTER

CASSETTE TAPES OF SCIENTIFIC SESSIONS

are available from American Audio Association in the Registration area.

PROGRAM *(continued)*



FRIDAY AFTERNOON, APRIL 26

12 Noon-1:45 pm **LUNCHEON**
(By ticket only)
Golden West & California Rooms

BUSINESS SESSION IV

Town & Country Room
Moderator: BURTON H. PRESS, DDS, Alamo, CA

2:00 pm-5:00 pm Delivery & reimbursement: They're changing — are you?
Panel: MYRON J. BROMBERG, DDS, Reseda, CA;
JOHN F. FIELD, DDS, San Francisco;
JESSE D. MILLER, JD, Los Angeles;
RICHARD E. SCHMIDT, DDS, San Diego

An up-to-the-minute report and analysis of recent legislation and caselaw and their impact on the practice of dentistry. Also discussed will be some of the legal limitations and restrictions operative on organized dental groups in aggressive representation of members, and certain cautions to observe regarding alternative delivery systems.

SCIENTIFIC SESSION IV

San Diego Room
Moderator: JOSEPH J. WILLIAMS, DDS, Boston

2:00 pm-5:00 pm Genetic engineering in endodontics
HAROLD C. SLAVKIN, DDS, Los Angeles
Genetic engineering has a number of biotechnical advantages, including many applications related to clinical dentistry. Recent advances in recombinant DNA technology are enhancing diagnosis, therapy, post-therapy predictions and prevention. This biotechnology is developing novel procedures to induce new bone, cartilage, skin, enamel, dentin, and even cementum. Highlights from this "biological revolution" will be presented.

SPECIAL SESSION

(For members and spouses)
Senate & Committee Rooms
Moderator: MARSHALL D. PEIKOFF, DDS, MSD, Winnipeg, Canada

4:00 pm-5:30 pm The joys of wine: Its humor, history and health
HERBERT F. SPASSER, DDS, New York

The life of wine, like that of a man, is molded by the circumstances it faces over time. As we ourselves alter in form, if not essence, so do the wines stored in a cellar or on a shelf. So also do our judgements of them. Dr. Spasser will enhance the way we look at the wine we drink, and the pleasure we derive from it. On the lighter side, Dr. Spasser will highlight the history and humorous lore of wine.



NEED A BREAK?

Visit the Technical Exhibits. Complimentary coffee service will be provided in the Exhibit Area (Presidio Room) on Thursday and Friday, 10:30 am-12 noon and 2:30 pm-4:00 pm.



SMOKING

For the comfort of others, no smoking is permitted in the meeting rooms.



SATURDAY MORNING, APRIL 27

8:00 am- **CONTINENTAL BREAKFAST**
8:45 am (By ticket only)
Golden West & California Rooms

8:00 am- **EXHIBITS**
12 Noon Presidio Room

BUSINESS SESSION V

Town & Country Room

Moderator: DONALD E. ARENS, DDS, MSD, Indianapolis

9:00 am- Dentistry — the reports of our demise are premature
12 Noon BURTON H. PRESS, DDS, Alamo, CA

If you're a contrarian, now is the time to invest in dentistry. What are the socio-political forces impacting the health professions and is there a future for you and me? Come and participate in a lively discussion.

RESEARCH SEMINARS IV

San Diego Room

Moderator: JOSEPH I. TENCA, DDS, Boston

9:00 am The effects of CO₂ ice on PFM restorations
KEITH KRELL*, DDS, MS, MA;
SANDRA MADISON, DDS, MPH, MS;
RICHARD D. JORDAN, DDS, MS, University of Iowa

9:15 am Rubber dam retainers: effects on porcelain-fused-to-metal restorations
SANDRA MADISON*, DDS, MPH, MS;
RICHARD JORDAN, DDS, MS;
KEITH KRELL, DDS, MS, MA, University of Iowa

9:30 am Endodontic access openings through cerestore crowns
PAUL TEPLITSKY*, DMD, MS;
J. KENNETH SUTHERLAND, DMD, MS,
University of Saskatchewan

9:45 am Efficacy of different pulp testing procedures
ZVI FUSS*, DMD; BRUCE RICKOFF, DDS;
HENRY TROWBRIDGE, DDS, PhD;
I. B. BENDER, DDS, Albert Einstein Medical Center
and University of Pennsylvania

10:00 am Controlled released of endodontic medicaments
ZU-PYN YANG*, DDS; LEIF TRONSTAD, DID, PhD;
MARTIN TROPE, BDS; FREDERIC BARNETT, DMD,
University of Pennsylvania

10:15 am Canal wall thickness of mandibular molars after
different preparation techniques
STEVE MONTGOMERY, DDS,
University of Texas at San Antonio

10:30 am Low temperature injection of gutta-percha: A
scanning electron microscope investigation
MARIO CZONSTKOWSKY*, DDS, MDS;
ANDREW MICHANOWICZ, DDS;
NICHOLAS PIESCO, PhD, University of Pittsburgh

10:45 am The use of a dentinal bonding agent as a root canal
sealer
OMAR ZIDAN*, BDS, HDD, MS, PhD;
MAHMOUD ELDEEB, BDS, MS,
University of Minnesota

11:00 am Bacteriological status of the root canal after sonic,
ultrasonic and hand instrumentation
FREDERIC BARNETT*, DMD; MARTIN TROPE, BDS;
MOHAMAD KHOJA, DDS;
LEIF TRONSTAD, DMD, PhD,
University of Pennsylvania

11:15 am Performance of endosonics in curved root canals
BRUCE CHENAIL, DMD, MS;
PAUL TEPLITSKY*, DMD, MS,
University of Saskatchewan

11:30 am Apical seal using calcium hydroxide sealers with
laterally condensed gutta-percha
JOEL ALEXANDER*, DDS, MA;
TERENCE GORDON, BDS,
University of Texas at San Antonio

11:45 am Evaluation of three materials for the repair of
furcation perforations
RAMON AGUIRRE*, CD, MS, University of Missouri;
MAHMOUD ELDEEB, BDS, MS;
MOHAMED ELDEEB, BDS, DOS, MS,
University of Minnesota

*PRESENTER

PROGRAM *(continued)*



SATURDAY MORNING *(continued)*

9:00 am-
12 Noon

POSTER CLINICS Friars Room

- PC 1** Periapical pathology and electronic canal measurement
AIDA A. CHOAYEB, DDS, MSD, Washington, DC
- PC 2** Comparison of traditional and ultrasonic methods of instrumentation
DONALD M. COLLINSON, DDS, Edmonton, Canada
- PC 3** A comparison of intermediate and long-acting local anesthetics for endodontic therapy
JOEL L. DUNSKY, DDS, Boston
- PC 4** Dentinal hypersensitivity — its biological basis
G. REX HOLLAND, BDS, PhD, Edmonton, Canada
- PC 5** The endodontic periapical lesion: pictorial review and recent advances
ALAN NEVINS, DDS and PETER CERAVOLO, DDS, East Meadow, NY
- PC 6** A scanning electron microscopic study of usage wear on endosonic files
GERALD L. SCOTT, DDS, Iowa City
- PC 7** PDL injection — evaluating the extent of anesthesia and post anesthetic discomfort
RICHARD E. WALTON, DMD, MS and JOSEPH D'SOUZA, DDS, Iowa City
- PC 8** The effect of apical dentin plug length on canal sealability
KENNETH L. ZAKARIASEN, DDS, MS, PhD, Edmonton, Canada
- PC 9** A new method for evaluating leakage in the root canal system
THOM C. DUMSHA, DDS, MS, Baltimore, MD and ERIC HOVLAND, DDS, MBA, Louisville, KY

GRADUATE-STUDENT SECTION

- PC 10** Making of a cast post and core following fabrication of the crown
JAMES L. BRAMBLE, DDS and JACK H. BAUR, DDS, West Virginia University
- PC 11** A light microscopic and SEM study of pulps from traumatized teeth
THOMAS J. CIPRIANO, DDS, MS, University of Iowa
- PC 12** Comparison of two techniques in obtaining mandibular anesthesia
DARRELL A. DANG, DDS, University of Iowa
- PC 13** Gutta-percha: thermochemical properties
ASUNCION GARCIA-CASARES, MD, DMD, Boston University
- PC 14** The Mohorn technique for repairing mandibular molar perforations
KATHY L. JEFFERSON, DDS, and LINDA G. LEVIN, DDS, University of North Carolina

9:00 am-
12 Noon

TABLE CLINICS

Padre & Sierra Rooms

- TC 1** The phoenix restoration
JOHN T. BIGGS, DDS, MEd, MS and CLYDE L. SABALA, DDS, Oklahoma City
- TC 2** Referred pulpal pain
JOSE LUIS MEMBRILLO, DDS, MSD and GRACIELA CORTES, DDS, MS, Torreon, Mexico
- TC 3** The sectional warm gutta-percha technique
AHMAD FAHID, DDS, MA, Los Angeles and JERRY F. TAINTOR, DDS, MS, Sherman Oaks, CA
- TC 4** A simple and accurate technique for measuring root canal length
NOBORU INOUE, DDS, DDS, Tokyo, Japan
- TC 5** The use of the electro-mallet for retrograde removal of twist-off silver points
JAMES H. ISSACSON, DDS, San Diego
- TC 6** Root canal preparation: a comparison of mechanical and endosonic preparations
JEAN-MARIE LAURICHESSE, DDS, and GERARD ARMANDOU, DDS, Paris, France
- TC 7** The AG100 — a simplified portable system for radiographs in the school clinic
CESAR MEXIA de ALMEIDA, MD, DDS, Lisbon, Portugal





TC 8 The supersonic endodontic system: preparation and obturation
ATSUMU MIYAHARA, DDS, Higashiosaka, Japan and
JOSEPH D. MAGGIO, DDS, Chicago

TC 9 Saving the molar with a perforated furcation
JAMES B. ROANE, DDS, MS, and
FRED W. BENENATI, DDS, MEd, Oklahoma City

TC 10 The insulin syringe and pediatric endodontics
MANUEL I. WEISMAN, DDS, Augusta, GA

TC 25 Opioid carrier method
HARUHIRO OHTSU, DDS, Tokyo, Japan

GRADUATE-STUDENT SECTION

TC 11 A technique for isolating the crownless tooth
ROBERT E. WIDIS, DDS, University of North Carolina

TC 12 Solving isolation problems
JOHN D. BRAMWELL, DDS, and
GERALD M. CIMIS, DDS, MBA, Naval Dental School

TC 13 Surgical trephination, indications and technique
DINA CHELM, DDS and DAVID J. PARKINS, BDS,
Baylor College of Dentistry

TC 14 A matter of splinting
AMY B. DUKOFF, DMD,
Kingsbrook Jewish Medical Center

TC 15 Retrograde endosonics
ROBERT K. FLATH, DDS, and
MARION C. ELDRIDGE, DMD, Naval Dental School

TC 16 A light and scanning electron microscopic
evaluation of the Boston University cleaning and
shaping method
IRA S. HANDELSMAN, DDS and
THOMAS R. BIZIOREK, DDS, Boston University

TC 17 Evaluation of root canals using an endosonic
system
DEREK V. MILES, DMD and
ELMER J. NEAVERTH, DDS,
Medical College of Georgia

TC 18 Restoration of endodontically-treated posterior
teeth — An alternative to posts
RANDY W. OGDEN, DDS and
JOHN R. LUDINGTON, DDS, MSD,
University of Texas at Houston

TC 19 A three-dimensional approach to endodontic
therapy
TERRELL F. PANNKUK, DDS and
HOWARD J. LUDINGTON III, DDS, Boston University

TC 20 A comparison of instrumentation techniques using
modified and non-modified instrument tips
STEVEN EUGENE POWELL, DDS and
BRADLEY BEN MAZE, DDS,
VA Hospital Long Beach

TC 21 Flap design and management in periradicular
surgery
HEDLEY RAKUSIN, BDS, MSc and
RAMONA TORGERSON, DDS,
Baylor College of Dentistry

TC 22 Esthetic restorations for endodontically treated
anterior teeth
MICHELE REYNOLDS, DDS and
SANDRA MADISON, DDS, MPH, MS,
University of Iowa

TC 23 Diagnostic problem: cluster headaches mimicking
dental pain
WILLIAM J. ROME, DMD,
Wilford Hall Medical Center

TC 24 Repair of the furcation perforation
JOHN A. WEISENSEEL, DDS and
JOHN BERUDE, DDS, Naval Dental School



PROGRAM *(continued)*



SATURDAY MORNING (continued)

SCIENTIFIC SESSION V

Council Room

Moderator: *FULTON S. YEE, DDS, San Francisco*

- 9:00 am Injection of thermoplasticized low-temperature gutta-percha
ANDREW E. MICHANOWICZ, DDS;
MARIO CZONSTKOWSKY, DDS, MDS, and
JOHN P. MICHANOWICZ, DDS, Pittsburgh
An injection technique to fill root canals without the use of compaction will be introduced. The results of two and one-half years of *in vitro* testing with methylene blue, radioactive isotopes, and the scanning electron microscope will be shown. The preliminary results of a major clinical study being conducted at the University of Pittsburgh will be previewed.
- 10:00 am An update on chelation and flotation in endodontic practice
GEORGE G. STEWART, DDS, Philadelphia
Many years of both research and clinical experience have resulted in improved treatment procedures, since "EDTA and Urea Peroxide for Root Canal Preparation" was originally published. It is now more useful, not only in routine therapy, but also in the more complex problems that we are now called upon to deal with.
- 11:00 am Thirty-six years of root canal therapy with the precision controllable and biologic technique
YURY KUTTLER, DDS, MD, Mexico City, Mexico
It is possible that many root canal techniques, using a diversity of materials, do not achieve a success rate great enough to justify their constant use. Despite the modest success rate, these materials and techniques were used because of a lack of controlled study. Since 1948, much time has been spent in investigation, practice and comparison of various methods, resulting in the Precision, Controllable and Biologic Technique. This technique can be applied in 84% of fully developed and properly prepared and filled canals and obtains an 89.2% success rate from the correct therapeutic standpoint.



SATURDAY AFTERNOON, APRIL 27

- 12 Noon-1:30 pm **EDGAR D. COOLIDGE LUNCHEON**
(By ticket only)
Golden West & California Rooms
Speaker: LOUIS I. GROSSMAN, DDS
- 1:30 pm-5:30 pm **GENERAL ASSEMBLY MEETING**
Town & Country Room
- 7:00 pm-8:00 pm **PAST PRESIDENTS' RECEPTION**
Atlas Foyer
- 8:00 pm-Midnight **DINNER DANCE**
"The Black and White Ball"
Atlas Ballroom



SUNDAY, APRIL 28

- 8:00 am-8:45 am **CONTINENTAL BREAKFAST**
(By ticket only)
Presidio Room
- 8:00 am-12 Noon **AAE BOARD OF DIRECTORS MEETING**
Council Room
- SCIENTIFIC SESSION VI**
Padre & Sierra Rooms
Moderator: *JAMES GUTTUSO, DDS, West Palm Beach, FL*
- 9:00 am-12 Noon The management of pain in endodontics — 1985
STANLEY MALAMED, DDS, Los Angeles
This program will review many new developments that have occurred in the field of pain control over the past few years. Dr. Malamed will discuss drugs including bupivacaine, etidocaine, articaine, and 2-chloroprocaine; instruments including PDL syringes, newer needles, and changes in the local anesthetic cartridge; and techniques including Gow-Gates, Akinosi (closed mouth), PDL, and Bourgoyne (curved needle). Also discussed will be specific local anesthetic problems in endodontics.



CASSETTE TAPES OF SCIENTIFIC SESSIONS
are available from American Audio Association in the
Registration area.



AAE COMMITTEE MEETINGS

ALUMNI, STUDY CLUBS & OTHER GROUPS

Thursday, April 25, 12 Noon

Room

Dental Care and Clinical Practice El Camino
 Education Mesa
 Honors and Awards De Anza
 International Relations Adobe
 Research Mesa

Saturday, April 27, 7:30 am

Editorial Board Committee
 Member Services Forum
 Membership Cabinet
 Public and Professional Affairs Senate
 Student Affairs Cabinet

Friday, April 26, 7:30 am

Student Affairs (Student Member Orientation) ... De Anza/Mesa

Thursday, April 25

Room(s)

AADS Endodontic Section Meeting
 (5:00-6:00 pm) Padre/Sierra
 Army Endodontic Dinner
 (6:30-8:30 pm) Senate/Committee

Friday, April 26

Boston University Endodontic Alumni Cocktail Party
 (7:00-10:00 pm) Adobe/El Camino
 Florida Association of Endodontists Meeting
 (5:00-6:00 pm) San Diego
 Graduates of the Univ of Oregon and Univ of Ohio-
 Endodontics Dinner
 (7:30-9:30 pm) Council/Chamber/Cabinet
 Harry J. Healey Endodontic Study Club Breakfast
 (7:30-9:00 am) Towne
 Michigan Association of Endodontists Reception
 (6:00-8:00 pm) Committee
 Oklahoma Association of Endodontists Breakfast
 (7:30-9:00 am) El Camino
 State Endodontic Associations Meeting
 (2:00-5:00 pm) Council/Chamber/Cabinet
 University of Iowa Reception
 (6:00-8:00 pm) Forum
 University of Michigan Endodontic Alumni Breakfast
 (7:30-9:00 am) Adobe
 University of Washington Graduate Endodontics Alumni Dinner
 (6:30-8:30 pm) De Anza/Mesa
 Temple University Endodontics Alumni Association Reception
 (7:00-9:00 pm) Senate

Saturday, April 27

AAE Past Presidents' Breakfast
 (7:30-9:00 am) Sunset
 Boston University Endodontic Alumni Breakfast
 (8:00-9:30 am) Chamber
 Navy Endodontists Breakfast
 (7:30-9:00 am) De Anza/Mesa

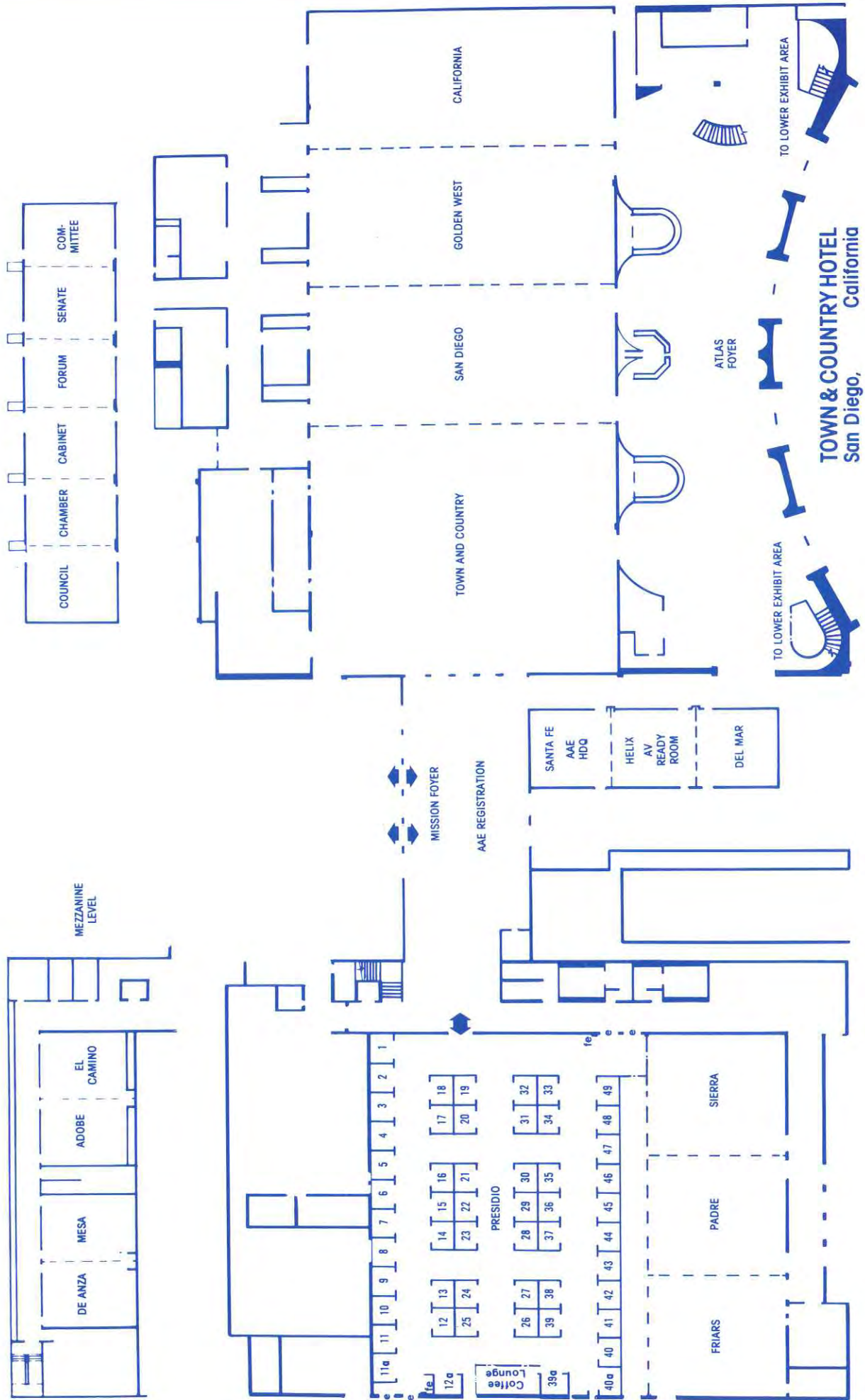

TOWN & COUNTRY HOTEL
San Diego, California



TECHNICAL EXHIBITORS

ADA Products, Inc. (Booth #2)
2350 West Florist Avenue
Milwaukee, WI 53209

Advanced Practice Systems, Inc.
(Booth #44)
5555 Oakbrook Parkway, Suite 110
Norcross, GA 30093

Amadent (Booth #33)
Box 733
Cherry Hill, NJ 08003

Analytic Technology (Booth #47)
3301 181st Place NE
Redmond, WA 98052

Block Drug Co. (Booth #3)
105 Academy Street
Jersey City, NJ 07302

L. D. Caulk Co. (Booths #35, 36, 37)
Clarke and Lakeview Avenues
P.O. Box 359
Milford, DE 19963

R. Chige, Inc. (Booth #49)
71A West Merrick Road
Valley Stream, NY 11580

Columbus Dental (Booth #28)
1000 Chouteau Avenue
P.O. Box 620
St. Louis, MO 63188

Dental Products Group International
(Booth #43)
15 West 17th Street
New York, NY 10011

Dentomatics (Booths #8, 9)
3185 "M" Street
Merced, CA 95340

Dermac "Touch of Mink" (Booth #5)
2485 Dallas Highway
Salem, OR 97304

Designs for Vision, Inc. (Booth #46)
120 East 23rd Street
New York, NY 10010

Ellman International Mfg., Inc. (Booth #13)
Ellman Building
1135 Railroad Avenue
Hewlett, NY 11557

Essential Dental Systems (Booth #39A)
119 West 57th Street
New York, NY 10019

Healthco International (Booth #34)
25 Stuart Street
Boston, MA 02116

Hu-Friedy Mfg. Co., Inc. (Booth #18)
3232 North Rockwell Street
Chicago, IL 60618

Hygenic Corp. (Booths #31, 32)
1245 Home Avenue
Akron, OH 44310

Inter-Dent (Booth #24)
391 Steelcase Road West, #16
Markham, ON, Canada L3R 2Z9

JS Dental Mfg., Inc. (Booth #40A)
110 Greene Street, #303A
New York, NY 10012

Kelly Systems, Inc. (Booth #40)
6735 Telegraph Road
Suite 205
Birmingham, MI 48010

Kerr Sybron (Booth #21)
28200 Wick Road
Romulus, MI 48174

Kilgore International, Inc. (Booth #7)
36 W. Pearl Street
P.O. Box 98
Coldwater, MI 49036

Knoll Pharmaceutical Co. (Booth #26)
30 North Jefferson Road
Whippany, NJ 07981

Lea & Febiger (Booth #4)
600 South Washington Square
Philadelphia, PA 19106

Lee Pharmaceuticals (Booth #6)
1444 Santa Anita Avenue
South El Monte, CA 91733

M & D International Enterprises, Inc.
(Booth #45)
517 Maple Avenue
P.O. Box 1294
Carpinteria, CA 93013

Medidenta International, Inc. (Booth #17)
39-23 62nd Street
Woodside, NY 11377

Microcopy (Booth #23)
1174 Tourmaline Drive
Newbury Park, CA 91320

C. V. Mosby, Co. (Booth #48)
11830 Westline Ind. Drive
St. Louis, MO 63146

Nephron Corporation-Dental Div.
(Booth #12)
3319 Pacific Avenue
Tacoma, WA 98408

Neupro Products (Booth #38)
P.O. Box 37
Dundee, IL 60118

Osada Electric Co., Inc. (Booth #41)
8242 West 3rd Street, Suite 150
Los Angeles, CA 90048

Palm Springs Seminars (Booth #12A)
2323 Oak Crest Drive South
Palm Springs, CA 92262

Parkell (Booth #10)
P.O. Box S
Farmingdale, NY 11735

Patterson Dental Co. (CENTRA)
(Booth #11A)
9899 Hibert Street
San Diego, CA 92131

Penn-Med Technology, Inc. (Booth #39)
Balligomingo Road, P.O. Box 71
West Conshohocken, PA 19428

Premier Dental Products Co. (Booth #25)
1710 Romano Drive
P.O. Box 111
Norristown, PA 19404

Pulpdent Corporation of America
(Booth #29)
75 Boylston Street
Brookline, MA 02147

Quality Aspirators (Booth #22)
1002 Dove Creek
Duncanville, TX 75116

Roydent Dental Products, Inc. (Booth #42)
508 Heath Row
Milford, DE 19963

Charles B. Schwed Co., Inc. (Booth #1)
138 Audley Street
Kew Gardens, NY 11418

Star Dental/Syntex Dental Products
(Booth #30)
P.O. Box 896
Valley Forge, PA 19428

Treloar & Heisel, Inc (Registration area)
402 First Federal Plaza
New Castle, PA 16101

Union Broach/A Health-Chem Co.
(Booths #19, 20)
1107 Broadway
New York, NY 10010

Unitek Corporation (Booths #14, 15, 16)
2724 South Peck Road
Monrovia, CA 91016

Williams and Wilkins (Booth #27)
428 East Preston Street
Baltimore, MD 21202

Xerox Medical Systems (Booth #11)
125 North Vinedo Street
Pasadena, CA 91007

Non-Technical Exhibits (Registration Area)

American Audio Association
50 Clinton Street, Suite 307
Hempstead, NY 11550
(Cassette tapes of Scientific Sessions)

AAE Career Counseling

AAE Endowment & Memorial Foundation



DIRECTORS

AMERICAN BOARD OF ENDODONTICS

1985

Joseph I. Tenca, President
Richard E. Walton
William H. Clem

1986

Garth A. James
Harold Gerstein
Raymond G. Luebke

1987

Stephen Cohen
John W. Harrison, Secy-Treas
Alvin A. Krakow



TRUSTEES

AAE ENDOWMENT AND MEMORIAL FOUNDATION

1985

Duane Compton, Secy-Treas
Maurice J. Friedman
Howard Martin
Manuel I. Weisman, Vice-President

1986

Raleigh R. Cummings
Bernard J. Grothaus
W. Paul Radman, President
Richard E. Schmidt

1987

Allan H. Cetron
Joel L. Dunsky
James L. Gutmann
Joseph M. Leavitt

PAST PRESIDENTS

*W. Clyde Davis	'43-44
*Ralph F. Sommer	'44-45
Robert G. Kesel	'45-46
*E. G. Van Valey	'46-47
Maynard K. Hine	'47-48
Louis I. Grossman	'48-49
*Elmer A. Jasper	'49-50
*Raymond L. Girardot	'50-51
*George G. Sharp	'51-52
F. Darl Ostrander	'52-53
Laurence A. Lucas	'53-54
*N. Weir Burkman	'54-55
*Harry J. Healey	'55-56
John R. Pear	'56-57
*George C. Hare	'57-58
George G. Stewart	'58-59
*J. Henry Kaiser	'59-60
*Paul P. Sherwood	'60-61
*Glenn R. Brooks	'61-62
Vincent B. Milas	'62-63
James H. Sherard, Jr.	'63-64
Jacob B. Freedland	'64-65
Henry S. Schmidt	'65-66
John I. Ingle	'66-67
Edwin C. Van Valey	'67-68
Samuel S Patterson	'68-69
Warren J. Hedman	'69-70
John F. Bucher	'70-71
Dudley H. Glick	'71-72
I. B. Bender	'72-73
Charles A. Scott, Jr.	'73-74
Alfred L. Frank	'74-75
Robert A. Uchin	'75-76
Frank B. Trice	'76-77
George A. Zurkow	'77-78
Harry Blechman	'78-79
Paul E. Zeigler	'79-80
Edward M. Osetek	'80-81
Henry J. Van Hassel	'81-82
Noah Chivian	'82-83
Donald E. Arens	'83-84

*Deceased



AAE AUXILIARY

The AAE Auxiliary will maintain a hospitality suite in the Tiki Hut at the Town & Country Hotel on Thursday, Friday and Saturday, 8:00-11:00 am & 1:00-4:00 pm, for all registered spouses.

AWARD RECIPIENTS

Edgar D. Coolidge Award

*Edgar D. Coolidge	'69
*Harry B. Johnston	'70
*Henry A. Bartels	'71
Bertram L. Wolfsohn	'74
Vincent B. Milas	'75
Worth B. Gregory	'78
Jacob B. Freedland	'80
Alfred L. Frank	'81
George G. Stewart	'82
F. Darl Ostrander & Maynard K. Hine	'83
*George C. Hare	'84

Louis I. Grossman Award

Louis I. Grossman	'73
*Birger Nygaard-Ostby	'76
I. B. Bender	'78
Samuel Seltzer	'80
Harold R. Stanley	'81
Kaare Langeland	'82
Henry J. Van Hassel	'84

Ralph F. Sommer Award

Calvin D. Torneck	'84
-------------------	-----

HONORARY MEMBERS

Mary C. Crowley
 Louis I. Grossman
 Maynard K. Hine
 Oscar A. Maisto
 Maury Massler
 Harold R. Stanley

OFFICERS

Mrs. James L. Klöss (Carol)	President
Mrs. Edwin S. Mehlman (Lesley)	President-elect
Mrs. Richard H. Yamanaka (Sharlene)	Vice-president
Mrs. Howard Pranikoff (Cheryl)	Secretary
Mrs. Victor L. Ratkus (Anne)	Treasurer
Mrs. Carl Tinkelman (Sydney)	Parliamentarian

WEDNESDAY, APRIL 24

3:30 pm- PRESIDENT'S WELCOME TEA
 4:30 pm Tiki Hut

4:30 pm BOARD MEETING
 Sunset Room

FRIDAY, APRIL 26

9:00 am- BUSINESS BREAKFAST
 11:00 am Sunrise & Sunset Rooms

Business will be mixed with pleasure at this breakfast featuring an enlightening presentation by Lizz Matto on the "Culture and cuisine of Mexico".

SATURDAY, APRIL 27

9:00 am- BOARD MEETING
 11:30 am Sunrise Room



ATTRACTION CONNECTION TOURS

From Thursday, April 25 to Saturday, April 27

Buses will depart every 30 minutes beginning at 9:00 am and the last bus will return by 5:30 pm. Stops include Balboa Park, Embarcadero, Harbor Cruise, Old Town, San Diego Zoo, Seaport Village and Sea World.



CONDENSED PROGRAM

WEDNESDAY, APRIL 24

8am-5pm	ABE Oral Exams	De Anza, Mesa, Adobe & El Camino
8:30am-5pm	Continuing Education	San Diego
9am-5pm	AAE Directors Meeting	Council
11 am-8pm	Registration	Mission Foyer
6pm-9:30pm	Welcome/Fellowship Reception	Sea World

THURSDAY, APRIL 25

8am-9:45am	Opening Session Breakfast	Golden West & California
8am-6pm	Registration	Mission Foyer
10am-5pm	Business Sessions I & II	Town & Country
10am-6pm	Exhibits	Presidio
10am-12	Scientific Session I	Padre & Sierra
	Research Seminars I	San Diego
12-1:30pm	Luncheon	On your own
1:30pm-5pm	Roundtable Seminars	See Program
	Research Seminars II	San Diego
2pm-5pm	Scientific Session II	Padre & Sierra
	Computer Workshop	Friars
5pm-6pm	AADS Endodontic Section Meeting	Padre & Sierra

FRIDAY, APRIL 26

6:00am	Fun Run	See Program
8am-8:45am	Continental Breakfast	Golden West & California
8am-5pm	Exhibits	Presidio
8am-5pm	Registration	Mission Foyer
9am-11 am	Roundtable Seminars	See Program

FRIDAY (continued)

9am-12	Business Session III	Town & Country
	Scientific Session III	Padre & Sierra
	Computer Workshop	Friars
	Research Seminars III	San Diego
12-1:45pm	Luncheon	Golden West & California
2pm-5pm	Business Session IV	Town & Country
	Scientific Session IV	San Diego
4pm-5:30pm	Wine Seminar	Senate & Committee

SATURDAY, APRIL 27

8am-8:45am	Continental Breakfast	Golden West & California
8am-12	Exhibits	Presidio
9am-12	Business Session V	Town & Country
	Poster Clinics	Friars
	Table Clinics	Padre & Sierra
	Research Seminars IV	San Diego
	Scientific Session V	Council
12-1:30pm	Coolidge Luncheon	Golden West & California
1:30pm-5:30pm	General Assembly Meeting	Town & Country
7pm-8pm	Past Presidents' Reception	Atlas Foyer
8pm-Midnite	Dinner Dance	Atlas Ballroom

SUNDAY, APRIL 28

8am-8:45am	Continental Breakfast	Presidio
8am-12	AAE Directors Meeting	Council
9am-12	Scientific Session VI	Padre & Sierra



PARTICIPANTS INDEX

A

Aguirre, Ramon, p. 13
Alexander, Joel, p. 13
Arens, Donald E., p. 13
Arlin, Steven R., p. 4
Armandou, Gerard, p. 14
Averbach, Robert E., p. 10

B

Baker, Mark C., p. 7
Bakland, Leif K., p. 4
Barkhordar, Rahmat A., p. 11
Barnett, Frederic, p. 13
Baumgartner, J. Craig, p. 11
Baur, Jack H., p. 14
Beierle, John W., p. 10
Benenati, Fred W., p. 15
Berude, John, p. 15
Biggs, John T., p. 14
Biziorek, Thomas R., p. 15
Bonica, John J., p. 6
Bramble, James L., p. 14
Bramwell, John D., p. 15
Brandell, D. Wylie, p. 7
Bravin, Robert, p. 4
Bromberg, Myron J., p. 12
Burns, Richard C., p. 4

C

Camp, Joe, H., p. 4
Carr, Gary B., p. 4
Ceravolo, Peter, p. 14
Chelm, Dina, p. 15
Chohayeb, Aida A., p. 14
Cimis, Gerald M., p. 15
Cipriano, Thomas J., p. 14
Cohen, Jay S., p. 9
Cohen, Stephen, p. 4
Collinson, Donald M., p. 14
Cortes, Graciela, p. 14
Cunningham, Walter T.,
pp. 8, 10
Curley, Arthur, p. 7
Cutler, Maurice, p. 4
Cyr, Gilbert, p. 11
Czarnecki, Roger T., p. 10
Czonstkowsky, Mario,
pp. 8, 10, 13, 16

D

Dang, Darrell A., p. 14
Dederich, Douglas N., p. 9
Dietz, Gerald C., pp. 8, 10
Dow, Pierre R., p. 6
Dreven, Lee J., p. 9
D'Souza, Joseph, p. 14
Dukoff, Amy B., p. 15
Dumsha, Thom C., p. 14
Dunsky, Joel L., p. 14

E

Eldridge, Marion C., p. 15

F

Fahid, Ahmad, p. 14
Field, John F., p. 12
Flath, Robert K., p. 15
Fuss, Zvi, p. 13

G

Garcia, Victor M., p. 7
Garcia-Casares, Asuncion,
p. 14
Glickman, Gerald N., p. 9
Goldman, Melvin, pp. 4, 7, 11
Goodman, Anthony D., p. 8
Grossman, Louis I., p. 16
Gutmann, James L., pp. 4, 6
Guttuso, James, p. 16

H

Hallberg, Edmond C., p. 10
Hallberg, Kaylene, p. 10
Handelsman, Ira S., p. 15
Hanson, Eugene C., p. 4
Hartwell, Gary R., p. 8
Hayes, Terrance W., p. 4
Held, Steven A., p. 8
Holland, G. Rex, pp. 11, 14
Hovland, Eric, p. 14

I

Ibarrola, Jose Luis E., p. 9
Inoue, Noboru, p. 14
Introcaso, Joseph H., p. 11
Isaacson, James H., p. 14

J

Jefferson, Kathy L., p. 14
Jerge, Ned W., p. 4

K

Kirk, John N., p. 9
Krell, Keith, p. 13
Kuttler, Yury, p. 16

L

Langeland, Kaare, p. 11
Laurichesse, Jean-Marie, p. 14
Levin, Linda G., p. 14
Levine, Mark E., p. 4
Loos, Larry G., p. 8
Luben, Richard A., p. 11
Ludington, John R., p. 15
Ludington, III, Howard J., p. 15

M

Madison, Sandra, pp. 13, 15
Maggio, Joseph D., p. 15
Malamed, Stanley, p. 16

Marlin, Jay, pp. 8, 10
Martin, Howard, pp. 8, 10
Mata, Estuardo C., p. 9
Maze, Bradley Ben, p. 15
McSpadden, John T., pp. 8, 10
Membrillo, Jose Luis, p. 14
Mexia de Almeida, Cesar, p. 14
Michaelides, Paul L., p. 10
Michanowicz, Andrew E.,
pp. 10, 16
Michanowicz, John P.,
pp. 8, 10, 16
Miles, Derek V., p. 15
Miller, Jesse D., p. 12
Miyahara, Atsumu, p. 15
Montgomery, Steve, p. 13
Mykleby, Brian A., p. 7

N

Neaverth, Elmer J., p. 15
Nevins, Alan, p. 14
Niccoli, Dominic, p. 4

O

Ogden, Randy W., p. 15
Ohtsu, Haruhiro, p. 15
Oliet, Seymour, p. 9
Orahood, James P., p. 9
Osetek, Edward M., pp. 4, 6

P

Pannkuk, Terrell F., p. 15
Pantera, Eugene A., p. 9
Parkins, David J., p. 15
Pascon, Elizeu A., p. 11
Patterson, Steven, p. 7
Pedicord, David W., p. 7
Peikoff, Marshall D., p. 12
Powell, Steven Eugene, p. 15
Press, Burton H., pp. 12, 13

R

Rabbio Maria A., p. 9
Rakusin, Hedley, pp. 8, 15
Reynolds, Michele, p. 15
Rickoff, Bruce D., p. 7
Roane, James B., p. 15
Rome, William J., p. 15
Rosenberg, Robert J., p. 7
Ross, John B., p. 8
Ruddle, Clifford J., p. 8
Ryskamp, Kirk R., p. 9

S

Sabala, Clyde L., p. 14
Safavi, Kamran, p. 11
Schleder, John R., p. 9
Schmidt, Gina, p. 4
Schmidt, Richard E., p. 12
Schwartz, Stephen F., p. 7

Scott, Gerald L., p. 14
Seidberg, Bruce H., p. 8
Selbst, Alan G., p. 8
Seltzer, Samuel, pp. 6, 11
Simmonds, Sidney W., p. 7
Slavkin, Harold C., p. 12
Spasser, Herbert F., p. 12
Srinivasan, Sunil R., p. 9
Stewart, George G., p. 16

T

Taintor, Jerry F., pp. 8, 14
Tanaka, Terry, p. 7
Taylor, Gary N., p. 8
Tenca, Joseph I., p. 13
Teplitsky, Paul, p. 13
Toglia, Joseph, p. 6
Torgerson, Ramona, p. 15
Trabert, Kenneth C., p. 8
Trobe, Martin, p. 11

V

Vreeland, David L., p. 9

W

Walton, Richard E., p. 14
Weichman, Jack A., p. 7
Weisenseel, John A., p. 15
Weisman, Manuel I., p. 15
Widis, Robert E., p. 15
Williams, Joseph J., p. 12

Y

Yamanaka, Richard H., p. 10
Yang, Zu-Pyn, p. 13
Yee, Fulton S., p. 16

Z

Zakariasen, Kenneth L.,
pp. 11, 14
Zeigler, Paul E., p. 4
Zidan, Omar, p. 13
Zinman, Edwin, p. 7



IMPORTANT NOTES

A series of horizontal blue lines for writing notes, spanning the width of the page.