

An Endodontic Space Odyssey



**American Association of Endodontists
47th Annual Session, April 25-29, 1990
Las Vegas, Nevada**



TABLE OF CONTENTS

	Page
AAE Board of Directors	3
ABE Board of Directors	22
Annual Session Committee	4
Award Recipients	23
Board & Committee Meetings	21
Exhibitors' Index	24
Floor Plan	25
General Information	5
Participants' Index	27
Past Presidents	23
Research & Education Foundation of the AAE	22
 Program	
Wednesday	6
Thursday am	7
Thursday pm	9
Friday am	11
Friday pm	14
Saturday am	16
Saturday pm	20
Sunday	20
AAE Auxiliary	22
Affiliates, Alumni & Other Groups	21

**American Association of Endodontists
47th Annual Session, April 25-29, 1990
Las Vegas, Nevada**



PRESIDENT'S MESSAGE

Welcome to the 47th Annual Session of the American Association of Endodontists. Because the annual session takes place in the exciting city of Las Vegas, we can all look forward to an unusually busy mix of social and professional activity. In recent years, Las Vegas has become the entertainment, sports and convention capital of the world and the number one destination for many meeting planners. Eighteen million visitors annually come to Las Vegas. The Riviera Convention and Resort Hotel is the most complete convention complex in Las Vegas. The good weather, wonderful low-cost housing and wide selection of activities make for a very festive setting for the serious business we will undertake in the days ahead. We will learn about the latest advances in our profession, and improve our skills and techniques, and share ideas with our colleagues. Our Board will meet, policies will be discussed and many plans will be decided upon which will affect our Association for many years to come.

Great numbers of you have traveled from all over the country to attend this meeting. We are also pleased to welcome our many international members and guests. While your professional experiences are varied, your interests have a certain commonality and that's the interest in quality Endodontics for the good of our patients. There will be an opportunity to attend lectures, browse through technical exhibits, listen to scientific papers and meet with your colleagues on a daily basis. I am sure that all of you will enjoy it as much as I will.

The theme for this year's meeting is "An Endodontic Space Odyssey." In reviewing the program, it is

obvious that Richard Burns, our General Chairman, has done his usual magnificent job in bringing to us a meeting that we will long remember. Our program chairman, Ed Osetek, has developed a well-thoughtout and widely diversified list of subjects which will be covered most thoroughly. Research Seminars directed by Mahmoud Torabinejad; Limited Attendance Seminars under the direction of Jeff Hoover; Table and Poster Clinics directed by Bob Steiman and the Wednesday C/E Course under direction of Robert Rosenberg will make this an educational space voyage long to be remembered.

Local arrangements this year are being ably directed by Craig Bell and his wife Riki, as Auxiliary liaison, from Reno, Nevada. Our sincerest thanks to you both.

A little known fact to many of our membership is that the annual meeting takes well over a year to bring to fruition. A great deal of time and effort goes into its planning. Our Executive Director, Irma Kudo, with the help of our Central Office staff who are here in Las Vegas, Laura Galusha, Letty Catrambone and Christine Bowden, must be commended for the dedication and perseverance that they show each year in taking care of the details of this most important annual session. Our thanks go out to the many participants and clinicians who are offering their skills for this meeting, for without them, success would not be possible.

It's almost impossible to come to Las Vegas without having an extraordinary time. The distractions are many, so be sure to save enough energy to participate in our annual meeting.

As your President, on behalf of all of the Board of Directors, I wish all of you good luck and good learning.

Gerald C. Dietz, Sr. DDS, MS
President



AMERICAN ASSOCIATION OF ENDODONTISTS

BOARD OF DIRECTORS

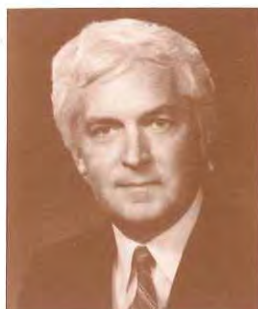

Gerald C. Dietz, Sr.
President



James C. McGraw
President-elect



Joseph I. Tenca
Vice President



Eric J. Hovland
Secretary



Stuart B. Fountain
Treasurer



Henry J. Van Hassel
Editor



Joseph D. Maggio
Immed. Past President



Irma S. Kudo
Executive Director

1990



Gary D. Gross
District II

1991



Philip W. Cohen
District IV

1992



Ronald I. Deblinger
District II



Terrence W. Hayes
District VI



Samuel O. Dorn
District III



James L. Gutmann
District V



Seymour Melnick
District I



Edwin S. Mehlman
District I



Donald D. Peters
District III



Darrell W. Zenk
District V



Bill R. Scharwatt
District VI



Jerome V. Pisano
District IV



ANNUAL SESSION COMMITTEE



Richard C. Burns
General Chairman



Edward M. Osetek
Program Chairman



W. Craig Bell
Local Committee
Chairman

Program

Continuing Education Robert J. Rosenberg
 Limited Attendance Seminars Jeffrey Hoover
 Research Seminars Mahmoud Torabinejad
 Table/Poster Clinics H. Robert Steiman
 Technical Exhibits Letty Catrambone

General Arrangements

Audio-Visual Bill Masheter
 Banquets & Meals Charles J. Cunningham & Anthony E. Dietz
 Dinner Dance Seating Pam Dietz & Carolyn Jennings
 Hosts Bradley J. Nelson
 Monitors James O. Roahen
 Signs Rush A. Lenroot
 Sports Ben B. Maze
 Luncheon with Learning Gregory T. Isermann
 AAE Auxiliary Chairperson Riki Bell

The statements and opinions expressed at the annual session are solely those of the individual speaker. Those statements and opinions do not reflect any endorsement by the American Association of Endodontists.



GENERAL INFORMATION

The Riveria Hotel will be the headquarters hotel for the 47th Annual Session.

AAE Headquarters - Convention Foyer

AAE headquarters office will be staffed by members of the Central Office. Letty Catrambone, Chris Bowden and Laura Galusha and by members of the Annual Session Committee. Office hours are 8 am-5 pm Tuesday through Sunday.

Exhibits - Room E&F

Because exhibitors help to defray some of the cost of the annual session, we encourage you to stop by the exhibits and place your order.

Complimentary coffee service will be provided on Thursday and Friday in the exhibit area, 10:30 am and 2:30 pm.

Exhibits hours are:

Thursday, April 26	10 - 6 pm
Friday, April 27	8 - 5 pm
Saturday, April 28	8 - 12 n

Cassette Tape Recordings

Teach'em Inc. will record many of the sessions presented. The cassette tapes are available for purchase in the Convention Foyer.

Continuing Education Credit

Academy of General Dentistry, California Board of Dental Examiners and Florida Certificates - all forms may be picked up and/or validated at the AAE headquarters office.

Registration - Convention Foyer

Registration fees include the following:

AAE members (excluding student members) - all sessions, Welcome/Fellowship Reception, one full breakfast (Thursday), two continental breakfasts, one breakfast brunch (Sunday), two lunches (Friday & Saturday) and one ticket to the Dinner Dance (Saturday). AAE student members - all sessions, Welcome/Fellowship Reception.

Non-member professionals, student and dental auxiliaries - all sessions.

Spouses - Welcome/Fellowship Reception and use of the Auxiliary hospitality suite.

Registration hours are:

Wednesday, April 25	11 - 8 pm
Thursday, April 26	8 - 5 pm
Friday, April 27	8 - 11 am

Saturday Dinner Dance

Your table selection for the Dinner Dance must be made as soon as possible before 5 pm on Thursday by exchanging your voucher for a banquet ticket at the AAE registration desk. If you wish to have a group seating, you must present a voucher for each person in your group in order to reserve the space. All vouchers must be presented at the same time. No exception will be made.

Speaker AV Ready Room - Room 17

Program participants are urged to review their audiovisual material in the speaker ready room prior to their presentation to avoid possible problems that may occur.

Video Taping is not allowed.



PROGRAM

WEDNESDAY, APRIL 25

CONTINUING EDUCATION COURSE

Room G-H (Pre-registration required)

Clinical adjuncts to endodontics

Moderator: **ROBERT J. ROSENBERG, DDS, DSD,**
San Francisco, CA

8:30 am Welcome

8:45 am Crown lengthening procedures
PAUL L. MICHAELIDES, DDS, MSD, Fresno, CA
A periodontist will present techniques for soft tissue and osseous recontouring that can be performed by the endodontist prior to root canal treatment and restoration.

10:45 am Orthodontic extrusion
VINCENT G. KOKICH, DDS, MSD, Tacoma, WA
An orthodontist presents indications and non-indications for orthodontic extrusion. Principles and case-presentations are used to illustrate management of this adjunctive procedure.

12:00 n Lunch

1:00 pm Build-up materials and usage
JACK I. NICHOLLS, PhD, Seattle, WA
An engineer by training who has spent a major portion of his career working with dental materials and their clinical usage will discuss the state-of-art materials available for post-endo restoration. Pros and cons of these materials based on extensive research will highlight this presentation.

3:00 pm Techniques for post obturation build-up
GALEN W. WAGNILD, DDS, San Francisco, CA
A practicing prosthodontist will present currently favored techniques for post-endo build-ups. These will be methods that can be employed by the endodontist.

4:30 pm Discussion

11:00 am - **REGISTRATION**

8:00 pm Convention Center Foyer

7:00 - **WELCOME/FELLOWSHIP RECEPTION**

9:00 pm Room A-D (by ticket only)



WELCOME/FELLOWSHIP RECEPTION

Wednesday, April 25, 7-9 pm

Spurs, chaps and 10-gallon hats are in order for this celebration of the old west! This will be an authentic western round-up of grub, suds and other libations to kick off the 47th Annual Session of the AAE. Networking opportunities abound as you meet with colleagues from around the world! Don't miss this chance to take a gander at what's in store for the next few days in Las Vegas.

SMOKING

For the comfort of others, no smoking is permitted in the meeting rooms.

RESERVE EARLY!

To reserve seats for the Dinner Dance on Saturday, vouchers must be exchanged for tickets no later than 5 pm Thursday. Parties wishing to sit together should return all vouchers at the same time. Your cooperation is greatly appreciated as we cannot extend this deadline.

THURSDAY MORNING, APRIL 26

8:00 - OPENING SESSION BREAKFAST

10:00 am Room A-B (by ticket only)
Keynote: GERALD C. DIETZ, Sr, DDS,
AAE President

8:00 am - REGISTRATION

5:00 pm Convention Center Foyer

10:00 am - EXHIBITS

6:00 pm Room E-F

SCIENTIFIC SESSION I

10:30 Room C-D

12:00 n Moderator: LESTER B. CHERNICK, DDS,
Chicago, IL

Space age retrofills: Alternatives to amalgam
SAMUEL O. DORN, DDS, Ft. Lauderdale, FL
ARNOLD H. GARTNER, DDS, Southfield, MI

For many years, amalgam has been accepted as the material of choice for retrofills in endodontic surgery. This presentation will review the surgical properties of amalgam and other suggested retrofilling materials. The speakers will then present a rationale and technique for using reinforced zinc oxide-eugenol cements as the new material of choice for filling the apical space.

SCIENTIFIC SESSION II

10:30 - Room I

12:00 n Moderator: JOHN W. HARRISON, DMD, MS,
Dallas, TX

The acute endodontic cellulitis syndrome: Biologic and clinical aspects

ROBERT J. MATUSOW, DMD, MS, Concord, MA

The cellulitis phenomenon is the most serious and pathogenic aspect of acute oral infection. The mechanism of this disease process will be presented with general dental and systemic infection implications, as seen in the primary endodontic cellulitis phase; distinctive from the "flare up" phase. Microbial etiology and its pathogenic potential, drug therapy considerations, diagnostic-prognostic factors and relatively early treatment resolution modalities on an ambulatory basis will also be included. Clinical aspects are correlated with an experimental endodontic cellulitis in a primate (immunologically induced). Histological photomicrographs illustrate the infection and pathological processes.

RESEARCH SEMINARS I

Room H

Moderators: FREDERIC BARNETT, DMD,
Philadelphia, PA
ROBERT J. ROSENBERG, DDS, DSD,
Greenbrae, CA

10:30 am Indirect immunofluorescence for identification of *Actinomyces* sp. in endodontic disease

EUGENE A. PANTERA, Jr *, R.J. GOHEAN &
G.S. SCHUSTER, Medical College of Georgia

10:45 am Dentin collagen cross-links of root-filled and normal teeth

ERIC M. RIVERA *, Univ of Iowa & M. YAMAUCHI,
Univ of North Carolina

11:00 am A volumetric and radiographic density comparison of three obturation techniques

CECIL E. BROWN, Jr, *, K. PANIETZ,
B.K. MOORE & C.W. NEWTON, Indiana Univ

11:15 am Evaluation of apicoectomy and retrofilling in dogs

SHIMON FRIEDMAN *, Temple Univ, I. ROTSTEIN
& A. MAHMID, Hadassah Univ

11:30 am Leakage patterns of various retrofilling materials in dogs

LARRY Z. KOREN *, S. FRIEDMAN, M. TROPE,
Temple Univ & I. ROTSTEIN, Hebrew Univ

11:45 am Effect of cavity depth on microleakage of four retrofilling materials

JORDAN L. SCHWEITZER *, L. CHRISTENSEN &
H. WALIA, Marquette Univ

12:00 n Periodontal response to experimental endodontic treatment and bleaching procedure

ZVI FUSS *, S. SZAJKIS & M. TAGGER,
Tel Aviv Univ

12:15 pm Healing of osseous defects associated with failed endodontically treated teeth by using FDBA

ABDELHAMIED Y. SAAD * & E. ABDELLATIEF,
Univ of Egypt

*Presenter

NEED A BREAK?

Visit the Technical Exhibits. Complimentary coffee service will be provided in the Exhibit Area on Thursday and Friday, 10:30 am and 2:30 pm.

THURSDAY MORNING (continued)

LIMITED ATTENDANCE SEMINARS

10:30 - Limited seating. NO standing permitted.
12:00 n

LAS 1 - Room 2
The cast gold post and core revisited - an expanded endodontic service
MANUEL I. WEISMAN, DDS, Augusta, GA
The scope of endodontics includes post and core construction. The cast gold post and core can be an integral part of endodontic service in which the entire technical procedure is done within the endodontic sphere. A complete temporization format is also presented. This LAS will be repeated Friday pm as LAS 19.

LAS 2 - Room G
The management of large periapical lesions of endodontic origin
CARL W. NEWTON, DDS, MSD, Indianapolis, IN
The role of the endodontist in treatment planning and the surgical and non-surgical treatment of large periapical lesions of pulpal origin are discussed and illustrated with case reports.

LAS 3 - Room J
OSHA: Understanding and complying with the rules
JOHN W. MYERS, DDS, MS, San Antonio, TX
Government regulations require that dentists provide training for hazards in the work place and for infection control. This seminar will provide an overview of the rules and recommendations concerning commercial programs that are available to help you comply with OSHA rules. This LAS will be repeated Saturday am as LAS 27.

LAS 4 - Room 1
Guidelines for publishing in the *Journal of Endodontics*
HENRY J. VAN HASSEL, DDS, MSD, PhD, Portland, OR
A panel from the Editorial Board and the Scientific Review Panel will discuss each of the elements of a successful manuscript. The panel will include Sandra Madison, Walter Doblecki, Charles J. Cunningham, Lisa Wilcox, M. Lamar Hicks and Donald D. Peters.

LAS 5 - Room 4
Intentional replantation
JAMES A. DRYDEN, DDS, MS, Joplin, MO
Sometimes conventional endodontic treatment or retreatment and/or surgery are not feasible. This presentation will discuss several case reports in which intentional replantation was used as a last resort treatment. This LAS will be repeated Friday pm as LAS 24.

LAS 6 - Room 3
Ratner bone cavity: Something to consider in your differential diagnosis
KENNETH J. SPOLNIK, DDS, MSD, Indianapolis, IN
A recently discovered oral disease process of infectious origin is described. This disease process is characterized by non-radiographically detectable, hollow, pathologic, alveolar cavities of variable size. The relationship between these cavities and idiopathic chronic facial pain is discussed.

BE IN THE KNOW ABOUT YOUR ASSOCIATION,

Attend your District Caucus and Reference Committee hearings Thursday Afternoon

DISTRICT CAUCUSES

2:00 - District I - Room 1
3:00 pm CT, DC, ME, MD, MA, PA, PR, RI, VT and VA

District II - Room 2
NJ and NY

District III - Room 3
FL, GA, NC, Air Force, Army, Navy, Public Health and Veterans Adm.

District IV - Room 4
IL, IN, KY, MI, OH, TN, WV and WI

District V - Room 5
AL, AZ, AR, CO, IA, KS, LA, MN, MS, MO, NE, NM, OK, SD, TX and UT

District VI - Room 6
AK, CA, HI, OR and WA

REFERENCE COMMITTEE HEARINGS

3:30 - Open forums to present your views on AAE
4:30 pm activities

Association Affairs Room 1
Communications/Publication Room 3
Education/Development Room 2
Member Services Room 1
Membership Room 2

AADS SECTION MEETING

4:30 -
5:30 pm Room 4

THURSDAY AFTERNOON, APRIL 26

A.B.E. GROSSMAN MEMORIAL LUNCHEON

- 12:00 - Top of Riv L Room (by ticket only)
1:45 pm Moderator: F. JAMES MARSHALL, DMD, MS,
Lake Oswego, OR

Professionalism personalized
TIM TIMMONS, Irvine, CA

SCIENTIFIC SESSION III

- 2:00 - Room C - D
3:30 pm Moderator: M. LAMAR HICKS, DDS, MS,
Bethesda, MD

Exploring radicular outer space - diagnosing periapical disease. What are you treating beyond the apex?
EVA C. DAHL, DDS, MA, MS, LaCrosse, WI

Most central bony lesions appearing in a periradicular location are inflammatory in nature secondary to pulpal degeneration. However, cystic and neoplastic diseases in this location may be easily confused with such endodontic lesions. An organized approach to the diagnosis of periapical disease will be presented illustrating the characteristics of these lesions, the importance of thorough evaluation, and the role of biopsy in appropriate cases.

SCIENTIFIC SESSION IV

- 2:00 - Room I
5:00 pm Moderator: JOSEPH D. MAGGIO, DDS,
Oakbrook, IL

Launching new communication probes for enhanced medical/dental communications for the 1990s
DARRICK E. ANTELL, DDS, MD, New York, NY
GEORGE J. DOHRMANN, MD, PhD, Chicago, IL
HOWARD S. SELDEN, DDS, Bethlehem, PA

This year, the Public and Professional Affairs Committee is launching a new effort to open the doors of communication with our physician colleagues in many medical disciplines.

This panel will focus on the clinical aspects of differentially diagnosing pain in the area of the head and neck with special emphasis on problems involving the maxillary sinuses. Knowing how to effectively communicate with our physician colleagues and when to seek assistance is critical to all of us in the day-to-day practice of endodontics. Panel participants include a plastic surgeon and a neurological surgeon.

GENERAL INTEREST SESSION I

- 2:00 - Top of Riv K Room
5:00 pm Moderator: ANNE RATKUS, South Burlington, VT

Maximum marriage or why women are so weird and men so strange
TIM TIMMONS, Irvine, CA

Maximum marriage is defined when a man and woman come into a dynamic intimate oneness and through their oneness find individuality. This seminar will explore the differences between men and women and will examine a strategy for developing an intimate relationship. Presented in conjunction with the AAE Auxiliary.

SCIENTIFIC SESSION V

- 3:30 - Room C-D
5:00 pm Moderator: F. JAMES MARSHALL, DMD, MS,
Lake Oswego, OR

Endodontic anatomy in the 4th dimension: Ten years of living in the space
L. STEPHEN BUCHANAN, DDS,
Santa Barbara, CA

In the last 10 years nearly everything in the field of endodontics - our concepts, our techniques, and our instruments - have changed subtly or radically. The only consistency during this period has been the anatomy of the inner space in which we work. Therefore, it is appropriate that we look at the past, present and future of our clinical experiences and conceptual understanding of these anatomic anomalies we call root canal systems.

This presentation will explore the work of anatomic researchers of the past, clinicians in the present, and the directions in which researchers and clinicians may be heading in the future.

RESERVE EARLY!

To reserve seats for the Dinner Dance on Saturday, vouchers must be exchanged for tickets no later than 5 pm Thursday. Parties wishing to sit together should return all vouchers at the same time. Your cooperation is greatly appreciated as we cannot extend this deadline.

THURSDAY AFTERNOON (continued)

RESEARCH SEMINARS II

Room H

Moderators: H. ROBERT STEIMAN, DDS,
Detroit, MI
SAMUEL SELTZER, DDS,
Philadelphia, PA

Graduate student section

- 2:00 pm Comparison of PMN protease & inhibitor levels in dental pulp
CINDY R. RAUSCHENBERGER *, S. McCLANAHAN,
D. TURNER, E. KAMINSKI, E. PEDERSON &
E. OSETEK, Northwestern Univ
- 2:15 pm Electrothermal debracketing of orthodontic appliances. Effects on the human pulp
JOSEPH S. DOVGAN *, R.E. WALTON &
S. BISHARA, Univ of Iowa
- 2:30 pm Detection of *Bacterioides gingivalis* by the polymerase chain reaction
TERRYL A. PROPPER *, L.G. LEVIN,
H.M. REISNER & P.H. DENTON,
Univ of North Carolina
- 2:45 pm Evaluation of the infraorbital nerve block in human maxillary anesthesia
GERHARD A. BERBERICH *, A. READER,
M. BECK & W. MEYERS, Ohio State Univ
- 3:00 pm Comparison of incisive and incisive/IAN blocs in human mandibular anesthesia
ROBERT A. NIST *, A. READER, M. BECK &
W. MEYERS, Ohio State Univ
- 3:15 pm Bilateral IAN blocks and infiltrations in human mandibular anterior anesthesia
THOMAS A. YONCHAK *, A. READER, M. BECK &
W. MEYERS, Ohio State Univ
- 3:30 pm Effect of processing conditions on determination of root length radiographs
GERALD J. HALK *, J.F. CORCORAN &
S. BROOKS, Univ of Michigan
- 3:45 pm Evaluation of a new method for silver point removal
KENT A. SPRIGGS *, B.H. GETTLEMAN,
H.H. MESSER, M.E. ELDEEB, Univ of Minnesota
- 4:00 pm Incidence and morphology of apical deltas in canine teeth of dogs
DAVID J. GAMM *, P. HOWARD, D. NENCKA &
H. WALIA, Marquette Univ
- 4:15 pm In vivo evaluation of irrigation during manual and sonic cleaning and shaping procedures
YVES M. YANA * & H. SCHILDER, Boston Univ

4:30 pm Neurotoxicity of solvents and irrigating solutions used in endodontic treatment
JAMES G. COYNE *, R.L. ELLISON,
J.F. CORCORAN & R. BRADLEY, Univ of Michigan

4:45 pm Evaluation of the antibacterial effects of intracanal NdYAG laser irradiation
MICHAEL W. HARDEE *, L. MISERENDINO &
W. KOS, Marquette Univ

RESEARCH SEMINARS III

Room J

Moderators: JOHN W. HARRISON, DMD, MS,
Dallas, TX
RONALD R. LEMON, DMD,
New Orleans, LA

- 2:00 pm Reactions to fluoride solutions in direct pulp capping
GEORGE M. McWALTER *, Univ of Texas at San Antonio & A.H. KAFRAWY, Indiana Univ
- 2:15 pm Further investigations into the nature of reparative dentin
MELVIN GOLDMAN *, P. ROSSETTI & R. WHITE,
Tufts Univ
- 2:30 pm Heat content changes of dentin during evaporative water loss
HAROLD E. GOODIS *, B.G. YEE, Univ of Calif San Francisco, D.H. PASHLEY & L. TAO, Medical College of Georgia
- 2:45 pm Sympathetic axons in ferret dental pulp
G. REX HOLLAND*, V. BURGESS &
E. PEHOWICH, Univ of Alberta, Canada
- 3:00 pm Pulpal blood flow: a study by laser doppler flowmetry
MELISSA B. CHAPMAN *, H. H. MESSER &
M. E. ELDEEB, Univ of Minnesota
- 3:15 pm Effect of immune complex formation on dentinal fluid flow
ALBERT TUTTLE *, Univ of North Carolina,
G. BERGENHOLTZ & M. JONTELL,
Univ Gothenburg
- 3:30 pm Isolation of HIV in the dental pulp of a patient with AIDS
MARTIN TROPE *, M. GLICK, O. BAGASRA &
M. E. PLISKIN, Temple Univ
- 3:45 pm Determination of pulp vitality following cast restorations
SANDRA MADISON *, D. FELTON, J. LEEB,
M. KANTOR & E. KANOY, Univ of North Carolina

* Presenter

FRIDAY MORNING, APRIL 27

7:00 - STUDENT/NEW MEMBER BREAKFAST

8:30 am Top of Riv L Room

7:30 - CONTINENTAL BREAKFAST

8:30 am Riviera Buffet Room (by ticket only)

8:00 am - EXHIBITS

5:00 pm Room E-F

LIMITED ATTENDANCE SEMINARS

8:45 - Limited seating. NO standing permitted.

10:15 am

LAS 7 - Room 1

Rheumatic hearts, mitral valve prolapse, heart murmurs, and all that other stuff: Its importance to you, your patients, and their lawyers

GARY N. TAYLOR, DDS, MS, Maywood, IL

This program focuses on the etiology of the most common cardiac conditions and why it is essential to recognize serious potential consequences of even the most benign dental procedures. A major objective will be to establish a nomenclature for the dialogue which should exist between dentist and physician. There will also be a review of the most current recommendations for prophylactic coverage. This LAS will be repeated Saturday am as LAS 32.

LAS 8 - Room 2

Office and treatment records

DAVID D. FRANCISCO, DDS, MS,
Overland Park, KS

Suggestions for all office paperwork will be discussed, emphasizing better organization within the office, improved communication with patients or referring dentists, and especially stressing reduction in liability risk. Includes treatment letters, charts, registration, health insurance, consent forms and more.

LAS 9 - Room 3

Crack! Exposing the cracked tooth syndrome

I. JOEL LEEB, DDS, MSD, PhD, Durham, NC

You just "know" that the patient has a cracked tooth, but how are you to diagnose and manage the problem? Here is an opportunity to review the etiology, orderly methods of diagnosis and techniques of management of a perplexing problem.

LAS 10 - Room J

AIDS and the endodontist

JAMES C. KULILD, DDS, MS, Evans, GA

The impact of AIDS on clinical endodontics will be discussed in light of current oral manifestations, relevant statistical data, and infection control guidelines of the ADA, OSHA, and CDC. This LAS will be repeated Friday pm as LAS 23.

LAS 11 - Room G

Periapical infections - new bugs, new drugs

FREDERIC BARNETT, DMD, Philadelphia, PA

Anaerobic bacteria may survive and maintain an infectious disease process in the periapical tissues and may be responsible for endodontic failure. This presentation will focus on clinical cases refractory to conventional endodontic treatment and microbial identification, surgical and antibiotic therapies will also be discussed. This LAS will be repeated Saturday am as LAS 36.

LAS 12 - Room 4

Drug abuse and abusers in clinical endodontic practice

JERRY F. TAINTOR, DDS, MS, Memphis, TN

ROBERT C. BIESTERFELD, DDS, MS,
Brooklyn Center, MN

This seminar will address the complications that arise when the practitioner treats an addict, including the addict's appetite for "pain pills"; drug interaction difficulties; obtaining adequate anesthesia; and inadvertently contributing to the addict's addiction.

BADGES MUST BE WORN AT ALL OFFICIAL AAE FUNCTIONS.

FRIDAY MORNING (continued)

RESEARCH SEMINARS IV

Room H

Moderators: DAVID L. PITTS, DDS, MSD,
Seattle, WA
MAHMOUD TORABINEJAD, DMD, MSD,
Loma Linda, CA

Graduate Student Section

- 9:00 am Effectiveness of a brush in removing postinstrumentation canal debris
DANIEL M. KEIR *, Wilford Hall USAF Medical Ctr,
E.S. SENIA & S. MONTGOMERY, Univ of Texas at
San Antonio
- 9:15 am The effects of three instrumentation techniques on root canal configuration
DENNIS A. LESEBERG *, S. MONTGOMERY,
Univ of Texas at San Antonio
- 9:30 am Toxicity of a new endodontic sealer
DANIEL J. MOLLOY *, M. GOLDMAN, R. WHITE &
S. KABANI, Tufts Univ
- 9:45 am Studies of a new root canal sealer
HERBERT L. RAY, Jr * & S. SELTZER,
Temple Univ
- 10:00 am Prophylactic use of long-acting NSAID's for endodontic post-treatment pain
SUSAN L. MICKLOW *, J.F. CORCORAN,
R. J. GARDNER & J.C. DRACH, Univ of Michigan
- 10:15 am Effect of intracanal medicaments on the sealing ability of T.E.R.M.
RICHARD E. RUTLEDGE *, Wilford Hall USAF
Medical Ctr & S. MONTGOMERY, Univ of Texas at
San Antonio
- 10:30 am Microleakage patterns of a new endodontic sealer
JITKA M. JANICEK *, A. GANDHI, M. GOLDMAN,
R. WHITE, Tufts Univ & D. NATHANSON, Boston Univ

- 10:45 am Bacterial penetration of coronally unsealed endodontically treated teeth
BORASMY N. UNG *, M. TORABINEJAD &
L.K. BAKLAND, Loma Linda Univ
- 11:00 am In vitro coronal leakage measurement utilizing an electrochemical technique
MICHAEL L. MARK * & T.C. DUMSHA,
Univ of Maryland
- 11:15 am Evaluation of healing periapical lesions following endodontic treatment in ferrets
ASHRAF F. FOUAD *, B.R. RITTMAN,
R.E. WALTON & K.V. KRELL, Univ of Iowa
- 11:30 am Evaluation of periradicular wound healing in the presence of cavity varnish
GARY W. WAGNER * & J.W. HARRISON,
Baylor College of Dentistry
- 11:45 am Effect of surgical dressings on endodontic surgical wound healing
ERIC A. PETERSEN * & J.W. HARRISON,
Baylor College of Dentistry

* Presenter

SCIENTIFIC SESSION VI

- 8:45 - Room C-D
10:15 am Moderator: CHARLES J. CUNNINGHAM, DDS,
Lexington, KY

The odyssey of success and failure in endodontics
RALPH BELLIZZI, DDS, Fort Benning, GA

This presentation will take a panoramic view in time and space of some of the earlier parameters of success and failure and how they influenced our views of clinical practice. The classic criteria will be reviewed with the aid of clinical cases which challenge both clinical and patient expectations.

FRIDAY MORNING (continued)

LIMITED ATTENDANCE SEMINARS

10:30 - Limited seating. NO standing permitted.
12:00 n

LAS 13 - Room 1

Obturation systems using warm gutta-percha
GERALD N. GLICKMAN, DDS, MS, MBA,
Dallas, TX

Various root-filling techniques using warm gutta-percha have recently been introduced to the armamentarium of the specialty practice. Key elements of new technological obturation systems will be highlighted. Guidelines for effective usage of these filling systems will be presented along with cases typifying clinical achievement. This LAS will be repeated Saturday am as LAS 29.

LAS 14 - Room 3

Principles of osseointegration
RICHARD HAMILTON, DDS, MS, Las Vegas, NV

Understanding osseointegration is the key to proper utilization of implant systems in clinical practice. The purpose of this lecture is to acquaint the audience with osseointegration. This will be of interest to anyone thinking about working with implant systems.

LAS 15 - Room 4

Endodontic procedures in maintaining dental arch integrity
LOUIS E. ROSSMAN, DMD, Philadelphia, PA
KATSUEI MORI, DDS, Tokyo, Japan

The endodontist is often part of a team which helps to establish a treatment plan to maintain the integrity of the dental arch. Decisions as to whether endodontic procedures can salvage certain key teeth need to be made to insure the predictability of the treatment plan. This seminar will address itself to some of the more sophisticated procedures to resolve the unusual clinical problems that may arise. A step by step approach will be offered in areas such as forced eruption, posterior endodontic surgery and intentional replantation.

LAS 16 - Room 2

Endodontic emergencies — a decade later
VAN T. HIMEL, DDS, Memphis, TN

R. SCOTT GATEWOOD, DMD, Jackson, MS
SAMUEL O. DORN, DDS, Ft. Lauderdale, FL

Diplomates of the American Board of Endodontics were surveyed to determine if trends in treating endodontic emergencies have changed over the last decade. This seminar will explore the results of this survey and will include discussion of various treatment controversies such as antibiotics, analgesics, intracanal medicaments, open/close and trephination. This LAS will be repeated Saturday am as LAS 34.

LAS 17 - Room G

I had a problem with ...

GREGORY T. ISERMANN, DDS, MS, Milwaukee, WI

An opportunity will be given to the attendees to share their methods of problem solving relative to referrals, billing, staff, and unusual case histories.

LAS 18 - Room J

Office logistics of a single visit endodontic practice
DENNY W. SOUTHARD, DDS, MSD, Tulsa, OK
LINDA Z. SOUTHARD, DDS, MSD, Tulsa, OK

This presentation will examine office logistics to achieve patient scheduling and flow, staffing, financial arrangements, and time management, permitting "endodontics in a single visit" to be your modus operandi.

FRIDAY MORNING (continued)

SCIENTIFIC SESSION VII

9:00 - Room I
12:00 n Moderator: JACK A. WEICHMAN, DDS, JD,
Santa Monica, CA

Spaces — How little is too little and how much is too much?

CALVIN D. TORNECK, DDS, MS, Toronto, ON
SAMUEL SELTZER, DDS, Philadelphia, PA
HERBERT SCHILDER, DDS, Boston, MA

When is a root canal underfilled or overfilled? At what point is an underfilling or overfilling beneath the standard of care? This will be a controversial discussion about a controversial issue by a controversial panel. (No taping of this session will be permitted.)

SCIENTIFIC SESSION VIII

10:30 - Room C-D
12:00 n Moderator: JOSEPH I. TENCA, DDS, MA,
Weston, MA

Geriatric endodontics — the diminishing space
CARL W. NEWTON, DDS, MSD, Indianapolis, IN

The need and demand for dental services, including root canal treatment, for the future elderly population is anticipated to exceed the projected growth of this age group. This group is being targeted by dental education programs and advanced training through improved curricula, aging research, and publications. This presentation will compare the typical geriatric patient's endodontic needs to that of the general population.

NEED A BREAK?

Visit the Technical Exhibits. Complimentary coffee service will be provided in the Exhibit Area on Thursday and Friday, 10:30 am and 2:30 pm.

FRIDAY AFTERNOON, APRIL 27

LUNCHEON WITH LEARNING

12:00 - Room A-B (by ticket only)
1:45 pm Moderator: GREGORY T. ISERMANN, DDS, MS,
Milwaukee, WI

Presentation of the Louis I. Grossman Award and the Ralph F. Sommer Award.



SYNGCUK KIM
1990 Grossman
Award Recipient



LEIF TRONSTAD
1990 Sommer
Award Recipient

The **Louis I. Grossman Award** is given to an AAE member for cumulative publication of significant research studies which have made an extraordinary contribution to endodontology.

The **Ralph F. Sommer Award** is awarded for recognition to the principal author(s) of a publication of specific significance to the science and art of endodontology.

SCIENTIFIC SESSION IX

2:00 - Room C-D
5:00 pm Moderator: DANIEL R. KOZLOWSKI, DDS,
Merrillville, IN

Post space from two perspectives
LEE M. JAMESON, DDS, MS, Chicago, IL
JAMES B. ROANE, DDS, MS, Oklahoma City, OK

Many endodontically treated teeth need extensive restorations and require posts to retain the buildup and crown. Endodontists are well equipped to provide this service, provided they understand the effect of functional forces, selection of compatible materials, and demands of the prosthetic device. To this end, the effect of YAW, PITCH, ROLL and COMPRESSION as well as the limits of biologic width must be explored. These factors have a profound effect upon proper material selection and established restoration limits.

FRIDAY AFTERNOON (continued)

LIMITED ATTENDANCE SEMINARS

- 2:00 - Limited seating. No standing permitted.
3:30 pm
- LAS 19 - Room 1 (LAS 1 repeat)
The case and gold post and core revisited — an expanded endodontic service
MANUEL I. WEISMAN
- LAS 20 - Room G
To computerize or not to computerize
LES H. MULDORF, DMD, Poughkeepsie, NY
To computerize or not to computerize - that is the question. We just may need a computer to sort out the myths from the reality. This seminar will help the entry level office make a choice.
- LAS 21 - Room 2
Vital pulp therapy and the "Cvek pulpotomy"
ERNST H. EHRMANN, DDS, Melbourne, Australia
The preservation of pulpal vitality is the first duty of every dentist. The Cvek pulpotomy enables this to be achieved in traumatically exposed pulps of permanent teeth, even if such teeth have been left untreated for some days. The technique will be described and successful cases with long follow-up periods (up to 8 years) will be shown. These exhibit continuing vitality, formation of dentine bridges and a normal periapical appearance. This LAS will be repeated Saturday am as LAS 28.
- LAS 22 - Room 3
Endodontic retreatment: eliminating canal obstructions
PIERRE MACHTOU, DDS, Paris, France
This presentation will discuss in detail the removal of coronal restorations and radicular posts; removal of filling materials which may be of different types; and the renegotiation of the canal to the apex. This LAS will be repeated Saturday am as LAS 35.
- LAS 23 - Room J (LAS 10 repeat)
AIDS and the endodontist
JAMES C. KULILD
- LAS 24 - Room 4 (LAS 5 repeat)
Intentional replantation
JAMES A. DRYDEN

RESEARCH SEMINARS V

- Room H
Moderators: SANDRA MADISON, DDS, MS,
Chapel Hill, NC
STEVEN G. MORROW, DDS,
Loma Linda, CA
- 2:00 pm Shaping of simulated root canals using various endodontic hand instruments
PAUL M.H. DUMMER *, M. AL OMAR,
Cardiff Dental School
- 2:15 pm Root perforation risk while flaring canals with rotary instruments
CHRISTOPHER S. WENCKUS *, E.G. BARROWES,
N.A. REMEIKIS & J.E. VAN CURA, Univ of Illinois at Chicago
- 2:30 pm S.E.M. evaluation of the simultaneous penetrating-shaping technique on canal walls
CATHERINE R. RICCI *, J.M. LAURICHESSE,
Univ of Paris
- 2:45 pm Cleaning and shaping with a fiber optic laser: A S.E.M. study
GUY C. LEVY * d'Odontologie de Marseille
- 3:00 pm Cavitation activity in ultrasonic instrumentation
MAJINAH AHMAD *, A. GHANI, Univ of Malaya,
L.A. CRUM, R.A. ROY, C. CHURCH, National Ctr of Physical Acoustics
- 3:15 pm Interappointment flare-ups: incidence and related factors
RICHARD E. WALTON * & A. FOUAD, Univ of Iowa
- 3:30 pm Microleakage comparison of dentin bonding systems with glass ionomer
AIDA A. CHOAYEB *, Howard Univ, F. EICHMILLER & N. RUPP, ADAHF NIST
- 3:45 pm Growth curves and membrane proteins of B. endodontalis
JANTIEN A. HERWEIJER *, B.G. LOOS & M.E. NEIDERS, SUNY at Buffalo
- 4:00 pm Bacteria isolated from the apical 5-6 mm of ten root canals
J. CRAIG BAUMGARTNER *, USAIDR & W.A. FALKLER, Jr, Univ of Maryland
- 4:15 pm Further studies on extraradicular endodontic infections
FRANK J. CERVONE *, L. TRONSTAD, F. BARNETT & J. SLOTS, Univ of Pennsylvania

*Presenter

FRIDAY AFTERNOON (continued)

GENERAL INTEREST SESSION II

2:00 - Room I
5:00 pm Moderator: ALVIN A. KRAKOW, DDS, Boston, MA

The facts and myths of the process of Board certification — an update
AMERICAN BOARD OF ENDODONTICS DIRECTORS

This program is geared toward graduate students, Board-eligible endodontists, educationally qualified endodontists and program directors. It will provide an informative review of the functions and philosophy of the ABE and the steps involved in the certification process. A question and answer session will be included.



SATURDAY EVENING DINNER DANCE

7:30-Midnight

Take your final spin through the galaxy before landing from the Endodontic Space Odyssey. A truly elegant affair, the Dinner Dance provides the perfect setting to bid farewell to the 1990 Annual Session. Gourmet appetites will be satisfied by the four-star fare while the appetite of the soul will be soothed by the live music. Black tie is optional. A cash bar will precede the dinner.

SATURDAY MORNING, APRIL 28

7:30 - **CONTINENTAL BREAKFAST**
8:30 am Riviera Buffet Room (by ticket only)

8:00 - **EXHIBITS**
12:00 n Room E-F

LIMITED ATTENDANCE SEMINARS

8:45 - Limited seating. NO standing permitted.

10:15 am

LAS 25 - Room G

A clinical approach to mandibular molar surgery
RALPH BELLIZZI, DDS, Ft. Benning, GA
ROBERT J. LOUSHINE, DDS, Columbus, GA

A clear and concise approach to mandibular molar surgery which utilizes the current state of the art techniques and materials. Each step is illustrated and explained with the aid of detailed clinical photos.

LAS 26 - Room 3

Biology of pulpal diagnosis

STEVEN A. SIERASKI, DDS, MS, Palos Heights, IL

Painful and non-painful pulpal diagnosis will be examined from a biological viewpoint. Emphasis will be placed on the roles of intrapulpal pressure, vasculature, dentinal versus pulpal pain, and pulpal defense mechanisms.

LAS 27 - Room J (LAS 3 repeat)

OSHA: understanding and complying with the rules
JOHN W. MYERS

LAS 28 - Room 2 (LAS 21 repeat)

Vital pulp therapy and the "Cvek pulpotomy"
ERNST H. EHRMANN

LAS 29 - Room 1 (LAS 13 repeat)

Obturation systems using warm gutta-percha
GERALD N. GLICKMAN, DDS, MS, MBA, Dallas, TX

LAS 30 - Room 4

Indications and advantages for using the operatory microscope in endodontic surgery

GABRIELE PECORA, DDS,

CLAUDIO ABBONDANZA, MD, Rome, Italy

This presentation will deal with the use of the operatory microscope in endodontic surgery, with particular reference to the location of the apex, its preparation and the retrograde filling. The seminar will also stress the correct use of the microscope and the correct position of the dental surgeon and assistants.

SATURDAY MORNING (continued)

8:30 - TABLE CLINICS

11:30 am Room E-F

- TC 1 A new device for removing silver points
BRADLEY H. GETTLEMAN, DDS, MS, Phoenix, AZ
KENT A. SPRIGGS, DDS, Minneapolis, MN
- TC 2 Cortical trephination simplified
SCOTT A. JOHNSON, DMD, Dallas, TX
- TC 3 The cutting angle variation of an Hedstroem file during instrumentation: its influence in debris removal
GUY C. LEVY, Tustin, CA
- TC 4 An overview of guided tissue regeneration
SHAHAB NOORVASH, DDS, MS, Loma Linda, CA
SCOTT B. McCLANAHAN, DDS, MS, FPO
Seattle, WA
- TC 5 Preventing undesirable tissue changes during orthodontic root extrusion
MICHAEL V. PICCININO, DDS, Washington, DC
- TC 6 A new approach for successful retreatments: rationale and instrument selection
CATHERINE R. RICCI, DDS,
JEAN-MARIE LAURICHESSE, DDS, Paris, France
- TC 7 Quickview
J. TIM RUSSIN, DDS, Brandon, FL
- TC 8 Non-surgical repair of large furcal perforation
HARMEET D. WALIA, BDS, MDS, MS,
Milwaukee, WI

Graduate Student Section

- TC 9 Periapical evaluation subsequent to canal preparation with Nd:YAG laser vs. hand instrumentation
JAMES K. BAHCALL, DMD, Marquette Univ
- TC 10 The use of hydroxyapatite in perforation repairs
JENNY G. BAJALCALIEV, DDS,
DAVID J. TOCA, DDS, Northwestern Univ
- TC 11 Fast and safe eucapercha preparation
JACK P. CAMPBELL, DMD,
JEFFREY R. THORPE, DDS, Naval Dental School

- TC 12 Surgical flap design - getting to the root of the problem
KIRK A. CORY, DDS,
MICHAEL J. JEANSONNE, DDS,
Univ of Texas at Houston
- TC 13 Post design and final restoration of endodontically treated teeth
DAVID M. DOBIN, DDS,
MARNA M. NII, DDS, Northwestern Univ
- TC 14 Approach the endodontic retreatment case
MICHAEL R. FUKAWA, DDS, Northwestern Univ
- TC 15 Hemostatic/barrier materials for endodontic surgery
WILLIAM C. HIGHTOWER, DDS,
RICHARD E. GOLDEN, Jr, DDS,
Naval Dental School
- TC 16 The heat test: friend or foe?
KENNETH R. HUNTER, DDS,
CHRISTOPHER A. LENTO, DMD,
Naval Dental School
- TC 17 Cast glass post and core for endodontically treated teeth
C. RUSSELL JACKSON, DDS,
RALPH W. NIEMANN, DDS, West Virginia Univ
- TC 18 Retreatment of gutta-percha obturation with the sonic air handpiece
WILLIAM D. LUPER, DDS,
JOYCE L. AWRAMIK, DDS, Naval Dental School
- TC 19 Name that post
DONALD A. MILLER, DDS
MANUEL A. BUSTAMANTE, DDS, Loyola Univ
- TC 20 Mini-cone: an apparatus to enhance radiographic interpretation
~~CANCELLED~~
JAMES D. SYKES, DMD, Univ of Alabama
- TC 21 Endodontic files: use them as posts to retain core buildups
MARK W. TODD, DMD, Northwestern Univ
- TC 22 A review of nonsteroidal anti-inflammatory agents
BRADLEY A. TRATTNER, DDS,
OLGA FONSECA, DDS, Univ of Maryland

SATURDAY MORNING (continued)

8:30 - POSTER CLINICS

11:30 am Room H

- PC 1 Comparison of physical properties of endodontic absorbent paper points
JOHN F. CORCORAN, DDS, MS, Ann Arbor, MI
- PC 2 Effect of innovated instrument design on the curved root canal
RICHARD J. GARDNER, DDS, MS, Ann Arbor, MI
- PC 3 Effects of apical retention form during lateral condensation
ICHIROH KATSUUMI, DDS, PhD, Tokyo, Japan
- PC 4 Osseous reactions to modified diaket as a retrofill material
DANIEL J. NENCKA, DDS, Milwaukee, WI
- PC 5 The root canal sealing efficacy of a zinc oxide cement, cyanoacrylate and cavity varnish
KEVIN A. SHUGARS, DDS, Chicago, IL
- PC 6 Revision of root canal fillings
MICHAEL YAGGER, DMD, MS, Tel Aviv, Israel
- PC 7 Root canal filling status by obtura heated gutta-percha delivery system
TAMIYUKI TSUZUKI, DDS, PhD, Tokyo, Japan
- PC 8 Effects of endodontic retreatment in small vs large curved canals
LISA R. WILCOX, DDS, MS, Iowa City, IA
- Graduate Student Section**
- PC 9 The effect of accessory cone condensation on apical microleakage
KIRK R. BAUMGARDNER, DDS, Univ of Iowa
- PC 10 Effects of electronic dental instruments on patients with cardiac pacemakers
ASHRAF F. FOUAD, BDS, Univ of Iowa
- PC 11 Leakage of different retrograde filling materials in wet and dry environments
MARIA J. FOURNIER, DDS, Northwestern Univ
- PC 12 A histologic study of the effect of prosthodontic stabilization and therapy on vertical root fractures in dog teeth
JAMES F. GIANAKAKIS, DDS, Northwestern Univ

- PC 13 Vitality of human fibroblasts in different storage media
JAMES A. HILTZ, DMD, Temple Univ
- PC 14 Evaluation of gutta percha adaptation system using a metal carrier
JON J. JUHLIN, DDS, Univ of Iowa
- PC 15 Dye leakage comparison of lased and unlased apical plugs
ROBERT W. PASSLOFF, DMD, Tufts Univ
- PC 16 Evaluation of four methods of sealer placement in-vitro
ALFRED H. WIEMANN, III, DMD, Univ of Iowa
- PC 17 Cross-linking and maturation of dental pulp collagen
SHIZUKO YAMAUCHI, DDS, Univ of North Carolina
- PC 18 The presence and levels of tumor neorosis factor in human dental pulp tissue
CLAY S. ECKERT, DDS, Northwestern Univ

SCIENTIFIC SESSION X

9:00 - Room C-D

12:00 n Moderator: ROBERT ZELIKOW, DDS,
Highland Park, IL

Oral Medicine: AIDS, dentistry and infectious diseases
SOL SILVERMAN, Jr, DDS, MA, San Francisco, CA
Patients infected with the AIDS virus (HIV) have dramatically changed dental practice and attitudes. This course will provide information basic for understanding the biology and responsibility associated with HIV Immunosuppression and subsequent infections and tumors. Criteria for diagnosing the numerous oral manifestations and effective management will be discussed. Emphasis will be given to understanding the risk factors and guidelines for treatment.

SATURDAY MORNING (continued)

GENERAL INTEREST SESSION III

9:00 - Room I (Pre-registration required. By ticket only)
12:00 n Moderator: GERALD C. DIETZ, Jr, DDS, MS,
Birmingham, MI

Beyond the baby boom: target marketing in the '90s
PAULA PERICH, Chicago, IL

Remarkable social changes taking place in American society are having a dramatic effect on potential patient populations. This seminar will focus on the emerging leisure class who have the means and motivation to seek out quality dental care. Attendees will learn how to target this lucrative market and also learn the implications of the growing trends toward single-parent households, women in the workplace, smaller families and career switching. Case studies drawn from actual campaigns will illustrate successful use of target marketing techniques by individual dentists. This seminar identifies tomorrow's markets today, enabling attendees to shape their marketing strategies to enhance the growth of their practices in the next decade.

Audience: Young professionals.

LIMITED ATTENDANCE SEMINARS

10:30 - Limited seating. NO standing permitted.

12:00 n

LAS 31 - Room J

Planning for retirement

HAROLD GERSTEIN, DDS, Lake Geneva, WI

Should you retire? How will you prepare for retirement physically, psychologically and financially (before and after)? Where will you live and what will you do? The pros and cons of retirement as well as alternatives to full retirement will be addressed in this seminar.

LAS 32 - Room 1 (LAS 7 repeat)

Rheumatic hearts, mitral valve prolapse, heart murmurs and all that other stuff: its importance to you, your patients and their lawyers

GARY N. TAYLOR

LAS 33 - Room 4

False indications for endodontic surgery

NICOLA PERRINI, DDS, Pistoia, Italy

This presentation will examine the false indications for endodontic surgery, with stress on perforations, external resorptions and intractable cases. Fractured instruments, post and cores and prosthetic rehabilitations will also be discussed.

LAS 34 - Room 2 (LAS 16 repeat)

Endodontic emergencies

VAN T. HIMEL, R. SCOTT GATEWOOD &
SAMUEL O. DORN

LAS 35 - Room 3 (LAS 22 repeat)

Endodontic retreatment: eliminating canal obstructions

PIERRE MACHTOU

LAS 36 - Room G (LAS 11 repeat)

Periapical infections - new bugs, new drugs
FREDERIC BARNETT

SATURDAY AFTERNOON, APRIL 28

COOLIDGE LUNCHEON

12:00 - Room A-B (by ticket only)
1:45 pm Moderator: CHARLES J. CUNNINGHAM, DDS,
Lexington, KY

Cold open spaces

RONALD M. MILNARIK, DDS, MA, MS, Belleville, IL

Air Force Colonel Ron Milnarik, an AAE member, will present photographic highlights of his extraordinary adventure across the vast expanse of the White Continent, starting at its coast and reaching the South Pole itself in 50 days. His group included the first six Americans, first Indian, first Chilean and first two women to do so. (Suitable for the whole family.)

Presentation of the Edgar D. Coolidge Award.



ROBERT A. UCHIN
1990 Coolidge
Award Recipient

The **Edgar D. Coolidge Award** is presented annually to an AAE member who has had active participation in the AAE during the individual's professional lifetime and who has displayed leadership and exemplary dedication to dentistry and to endodontics.

2:30 - **GENERAL ASSEMBLY**
5:00 pm Room I

6:30 - **PAST PRESIDENTS' RECEPTION**
7:30 pm Convention Center Foyer

7:30 - **DINNER DANCE**
Midnight Room A-D (by ticket only)

SUNDAY, APRIL 29

8:00 - **"FAREWELL" BREAKFAST BUFFET**
9:00 am Room B-D (by ticket only)

SCIENTIFIC SESSION XI

9:00 - Room J
10:30 am Moderator: RALEIGH R. CUMMINGS, DDS,
Newport Beach, CA

Striving for excellence outside our usual space
DAVID D. FRANCISCO, DDS, Overland Park, KS

Our goal is to deliver outstanding patient care. As endodontists, much of our attention is directed to the preparation and filling of the pulp canal space. This presentation will remind us of other areas we can address during our endodontic procedures to provide the "ideal" treatment for the patient. Diagnostic, restorative, periodontal, and educational considerations will be presented.

GENERAL INTEREST SESSION IV

9:00 - Room I
10:30 am Moderator: PETER A. PAESANI, DDS,
Rockford, IL

Our space in the dental marketplace
GREGORY T. ISERMANN, DDS, MS,
Milwaukee, WI

This updated discussion will examine the various forms of dental benefit plans, payment modalities and factors influencing the employer's choice of dental plans and the impact these decisions have on the dentist and the specialist.



AFFILIATES, ALUMNI & OTHER GROUPS

WEDNESDAY, APRIL 25

US Army Assn of Endo 6-7 pm **Room**
18

THURSDAY, APRIL 26

Int'l Fed of Endo Assn 2-5 pm & 6-8 pm G
Loma Linda Univ Alumni 7-10 pm 3
Northwestern Alumni 6:30-8:30 pm 1
Tufts Univ Alumni 6-8 pm 18
UCLA Alumni 6-8 pm 2
UNC Alumni 6-7:30 pm 6
Univ of Maryland Alumni 6-8 pm 5
Univ of Minnesota Alumni 6:30-8:30 pm 8
Univ of Pennsylvania 6-8 pm Penn Suite
Univ of Pittsburgh Alumni 6-8 pm 7
US Army Assn of Endo 1-2 pm 2
US Army Assn of Endo Dinner 6-9 pm Top of Riv L
USC Alumni 6:30-9:30 J

FRIDAY, APRIL 27

Albert Einstein Medical Ctr Alumni 6-8 pm 1
Baylor College Alumni 5:30-7:30 pm 5
Boston Univ Alumni 7-8:45 am Top of Riv K
Boston Univ Alumni Dinner 7-10:30 pm B
Christian Endo Society 5-6 pm 21
F. James Marshall Dinner 7-10:30 pm Top of Riv L
Florida Assn of Endo 5-6 pm 20
Pennsylvania Academy of Endo 7-8:45 pm Kady's
Brasserie
Univ of Connecticut Alumni Assn 6:30-8:30 pm 6
Univ of Iowa Group 6-8 pm 8
Univ of Washington Alumni 6:30-8:30 pm 7

SATURDAY, APRIL 28, 7-8:45 am

Harry J. Healey Study Club 5
Oklahoma Assn of Endo 20
Univ of Michigan Alumni Assn 6
USAF Assn of Endo 7
US Navy Assn of Endo Top of Riv L



BOARD & COMMITTEE MEETINGS

MONDAY, APRIL 23

ABE Board of Directors 8-6pm **Room**
19

TUESDAY, APRIL 24

R&E Foundation Trustees 8-5 pm 5

WEDNESDAY, APRIL 25

AAE Board of Directors 8-5 pm 7-8
Honors & Awards 2-5 pm 18

FRIDAY, APRIL 26, 7:30-8:45 am

Ad Hoc Comm on Adv Standards 4:30-5:30 pm G
Dental Care & Clinical Practice 20
Editorial Board 5
Educational Affairs 6
Federal Dental health Services 19
International Relations 21
Student/New Member Breakfast Top of Riv L
Prof Standards, Peer Review & Ethics 18

SATURDAY, APRIL 27, 7:30-8:45 am

Member Services 8
Membership 18
Past Presidents' Breakfast Dietz's Suite
Public & Professional Affairs 22
Research & Scientific Affairs 19

SUNDAY, APRIL 29

AAE Board of Directors 8-1 pm 7-8



DIRECTORS

American Board of Endodontics 1990

William E. Bernier
Robert L. Ellison
Alvin A. Krakow

1991

M. Lamar Hicks
F. James Marshall, President
Edward M. Osetek, Secretary/Treasurer

1992

Leif K. Bakland
Louis E. Rossman
Robert Zelikow



TRUSTEES

RESEARCH & EDUCATION FOUNDATION OF THE AAE

1990

Paul D. Eleazer,
President
Gregory C. Galland
Carl W. Newton

1991

Gary R. Hartwell
Sandra Madison,
President Elect
John W. Myers,
Secy/Treasurer

1992

Harold E. Goodis
Peter A. Paesani
Carl L. Tinkelman

1993

Harmon R. Katz
Robert J. Rosenberg
Bruce H. Seidberg
Joel C. Small

Ex officio: Eric J. Hovland



TOURS

Las Vegas Highlights - \$28,
Wed 1-5 pm, Thu 9:15-1:15 pm
Red Rock Canyon & Old Nevada - \$35,
Thu, 9:45-3:45 pm
Hoover Dam & Chocolate Factory - \$33,
Fri, 9-3 pm

Pre-registration tickets are to be picked up at the tour desk in the AAE registration area. If seats are available, tickets will be sold on-site. All tours depart from the Convention Entrance of the Riviera Hotel.



AAE AUXILIARY

OFFICERS

Mrs. Ann Ratkus (Victor) President
Mrs. Linda Powell (William) President-elect
Mrs. Cheryl Pranikoff (Howard) Vice president
Mrs. Sue Zenk (Darrell) Secretary
Mrs. Carol Belanger (Laurent) Treasurer
Mrs. Shirley Novack (Harvey) Parliamentarian

THURSDAY, APRIL 26

7:45 - Auxiliary Welcome Breakfast - Top of Riv L Room
8:45 am Welcome to Las Vegas Presentation

2:00 - General Interest Session - Top of Riv K
5:00 pm Maximum marriage or why women are so weird
and men so strange
TIM TIMMONS, Irvine, CA

This seminar is for attendees and spouses alike. Come and hear an inspirational talk in which you discover the meaning of "maximum marriage" and how intimate relationships play a most important role in achieving it.

FRIDAY, APRIL 27

7:30 - Board meeting - Ratkus' Suite
8:45 am

1:00 - Hospitality - Ratkus' Suite
4:00 pm

SATURDAY, APRIL 28

8:15 - Auxiliary Brunch/Business meeting
10:45 am Top of Riv K

How to have your business and your life and family, too

KATHERINE ORDONA, Del Mar, CA

How to become an entrepreneur and make a million dollars

BEVERLY A. MARGOLIS, Utica, NY

A recipient of several awards and an experienced radio and talk show guest, Mrs. Margolis will speak about the trials and tribulations of being a woman in the business world and how to capitalize on them.

11:00 - Board meeting - Ratkus' Suite
12:00 n



PAST PRESIDENTS

* W. Clyde Davis	'43-44
* Ralph F. Sommer	'44-45
* Robert G. Kesel	'45-46
* E. G. Van Valey	'46-47
Maynard K. Hine	'47-48
* Louis I. Grossman	'48-49
* Elmer A. Jasper	'49-50
* Raymond L. Girardot	'50-51
* George G. Sharp	'51-52
F. Darl Ostrander	'52-53
Laurence A. Lucas	'53-54
* N. Weir Burkman	'54-55
* Harry J. Healey	'55-56
John R. Pear	'56-57
* George C. Hare	'57-58
George G. Stewart	'58-59
* J. Henry Kaiser	'59-60
* Paul P. Sherwood	'60-61
* Glenn R. Brooks	'61-62
* Vincent B. Milas	'62-63
James H. Sherard Jr.	'63-64
Jacob B. Freedland	'64-65
* Henry S. Schmidt	'65-66
John I. Ingle	'66-67
Edwin C. Van Valey	'67-68
Samuel S Patterson	'68-69
Warren J. Hedman	'69-70
John F. Bucher	'70-71
Dudley H. Glick	'71-72
I. B. Bender	'72-73
Charles A. Scott, Jr.	'73-74
Alfred L. Frank	'74-75
Robert A. Uchin	'75-76
Frank B. Trice	'76-77
George A. Zurkow	'77-78
Harry Blechman	'78-79
Paul E. Zeigler	'79-80
Edward M. Osetek	'80-81
Henry J. Van Hassel	'81-82
Noah Chivian	'82-83
Donald E. Arens	'83-84
Stephen F. Schwartz	'84-85
Herbert Schilder	'85-86
Michael A. Heuer	'86-87
Charles J. Cunningham	'87-88
Joseph D. Maggio	'88-89

* Deceased



AWARD RECIPIENTS

Edgar D. Coolidge Award

* Edgar D. Coolidge	'69
* Harry B. Johnston	'70
* Henry A. Bartels	'71
Bertram L. Wolfsohn	'74
* Vincent B. Milas	'75
Worth B. Gregory	'78
Jacob B. Freedland	'80
Alfred L. Frank	'81
George G. Stewart	'82
F. Darl Ostrander	'83
Maynard K. Hine	'83
* George C. Hare	'84
* Irving J. Naidorf	'85
Harry Blechman	'86
I. B. Bender	'87
Dudley H. Glick	'88
Samuel S Patterson	'89
Robert A. Uchin	'90

Louis I. Grossman Award

* Louis I. Grossman	'73
* Birger Nygaard-Ostby	'76
I. B. Bender	'78
Samuel Seltzer	'80
Harold R. Stanley	'81
Kaare Langeland	'82
Henry J. Van Hassel	'84
Melvyn Goldman	'89
Syngcuk Kim	'90

Ralph F. Sommer Award

Calvin D. Torneck	'84
Alfred L. Frank	'85
Mahmoud Torabinejad	'86
John I. Ingle	'87
Leif Tronstad	'90

HONORARY MEMBERS

Mary Crowley
* Louis I. Grossman
Maynard K. Hine
Oscar A. Maisto
Maury Massler
Harold R. Stanley
Henry O. Trowbridge



TECHNICAL EXHIBITS

(Booth #)	(Booth #)	(Booth #)
410 Almore Int'l Inc. 10950 SW 5th, Ste 270 Beaverton, OR 97005	115 Healthfirst Corp. 22316 70th Avenue W, Unit A Mountlake Terrace, WA 98043	314 Patterson Dental Company 1100 E 80th Street Minneapolis, MN 55420
100 Amadent P.O. Box 733 Cherry Hill, NJ 08003	120 Hu-Friedy Mfg. Company Inc. 3232 N Rockwell St Chicago, IL 60618	209 Premier-Espe/Premier 1710 Romano Drive, Box III Norristown, PA 19404
206 Analytic Technology Corp. 3301-181st Place NE Redmond, WA 98052	114 Hygenic Corp. 1245 Home Avenue Akron, OH 44310	221 Professional Results Inc./Tooth Slooth 29 Merano Laguna Niguel, CA 92677
319 Aseptico Inc. P.O. Box 3209 Kirkland, WA 98083-3209	219 JS Dental Mfg. Inc. P.O. Box 904 Ridgefield, CT 06877	307 Pulpdent Corp. 80 Oakland St, P.O. Box 780 Watertown, MA 02272
207 Astra Pharmaceutical Products Inc. 50 Otis Street Westborough, MA 01581	300 KComp Systems 535 N Brand Blvd, Ste 601 Glendale, CA 91203	108 Quality Aspirators P.O. Box 382120 Duncanville, TX 75138
405 Becker-Parkin Dental Supply Co. 245 Seventh Avenue New York, NY 10001	213 Kelly Systems Inc. 215 6735 Telegraph Road, Ste 205 Birmingham, MI 48010	101 Quintessence Publishing 870 Oak Creek Drive Lombard, IL 60148
109 Block Drug Company Inc. 257 Cornelison Avenue Jersey City, NJ 07302	316 Kerr Mfg. Company 28200 Wick Road Romulus, MI 48174	416 Rinn Corp-Greene Dental Products 1212 Abbott Drive Elgin, IL 60123
202 Brasseler USA 800 King George Blvd Savannah, GA 31419	404 Kilgore Int'l Inc. 36 W Pearl St/P.O. Box 98 Coldwater, MI 49036	310 Roydent Dental Products Inc. 6964 Crooks Road Troy, MI 48098
406 CMI Group 408 4533 US 220 North Summerfield, NC 27358	117 Knoll Pharmaceuticals 30 N Jefferson Road Whippany, NJ 07981	302 W.B. Saunders Company 85 Marly St Redlands, CA 92373
214 L.D. Caulk Company 216 P.O. Box 359 Millford, DE 19963	208 M&D Int'l Enterprises Inc. P.O. Box 1294/517 Maple Ave Carpinteria, CA 93013	407 Henry Schein Inc. 5 Harbor Park Drive Port Washington, NY 11050
308 Centrix Inc. 30 Stran Road Milford, CT 06460	105 Medidenta Int'l Inc. 39-23 62nd Street Woodside, NY 11377	305 Charles B. Schwed Co. Inc. 138 Audley St Kew Gardens, NY 11418
110 R. Chige Inc. 475 W Merrick Road Valley Stream, NY 11580	315 Microcopy 3120 Moon Station Road Kennesaw, GA 30144	301 Texceed Corp. 3001 Redhill Ave, Bldg 4-104 Costa Mesa, CA 92626
220 Dentsply/Equipment Division 570 W College Avenue York, PA 17405	412 Microdentics Inc. 100 Northfield Avenue West Orange, NJ 07052	415 Thermafil/Tulsa Dental 5001 E 68th St, Ste 500 Tulsa, OK 74136
313 Designs For Vision Inc. 760 Koehler Avenue Ronkonkoma, NY 11779	205 Miles Inc., Dental Products 4315 S Lafayette Blvd South Bend, IN 46614	Treloar & Heisel Inc. 3132 Wilmington Road P.O. Box 5168 New Castle, PA 16105 (Registration area)
306 Dunvale Corp. 141 Union Street Gilberts, IL 60136	320 J. Morita USA Inc. 14712 Bentley Circle Tustin, CA 92680	200 Uniflex Company 6964 Crooks Road Troy, MI 48099
113 Ellman International Mfg. Inc. 1135 Railroad Avenue Hewlett, NY 11557	201 Nat'l Dental Mutual Insurance Co. 155 Sansome St, Ste 620 San Francisco, CA 94104	106 Union Broach 1212 6th Ave New York, NY 10036
309 Encyclopaedia Britannica, USA 310 South Michigan Avenue Chicago, IL 60604	418 Navy Recruiting Command 4015 Wilson Blvd, CODE 122, Rm 203 Arlington, VA 22203-1991	
414 Endo Technic Corp. 3002 Dow Avenue, Ste 114 Tustin, CA 92680	413 Nephron Corp-Dental Division 3319 Pacific Avenue Tacoma, WA 98408	
107 Essential Dental Systems 7 W 36th Street New York, NY 10018	111 OMS/Omnitrac 3120 Crossing Park Norcross, GA 30071	
210 Healthco Int'l Inc. 25 Stuart Street Boston, MA 02116	409 Osada Electric Company Inc. 8242 W Third St, Ste 150 Los Angeles, CA 90048	

Non-Technical Exhibits

AAE Career Counseling
Research & Education Foundation
Teach'em Inc.
160 E Illinois St
Chicago, IL 60611

RIVIERA HOTEL

Meeting Room Layout

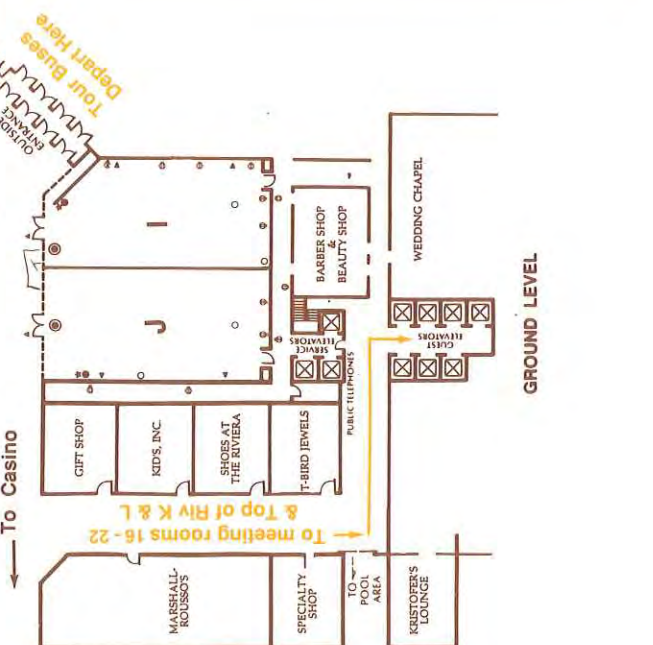
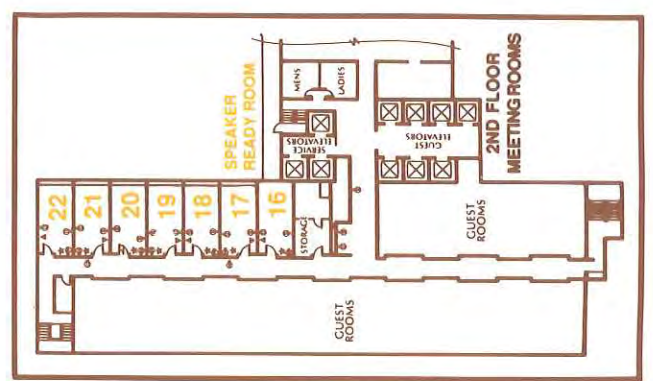
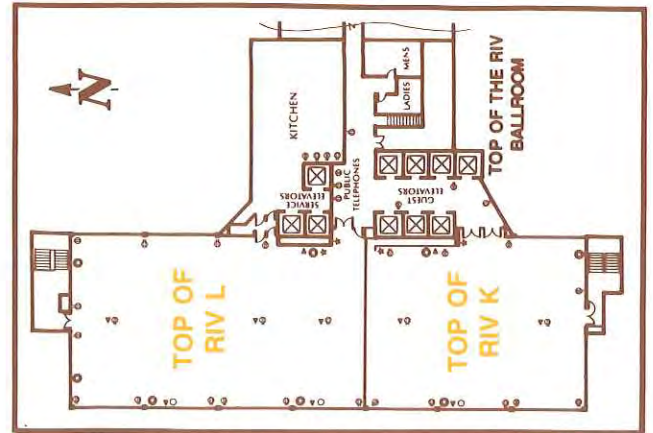
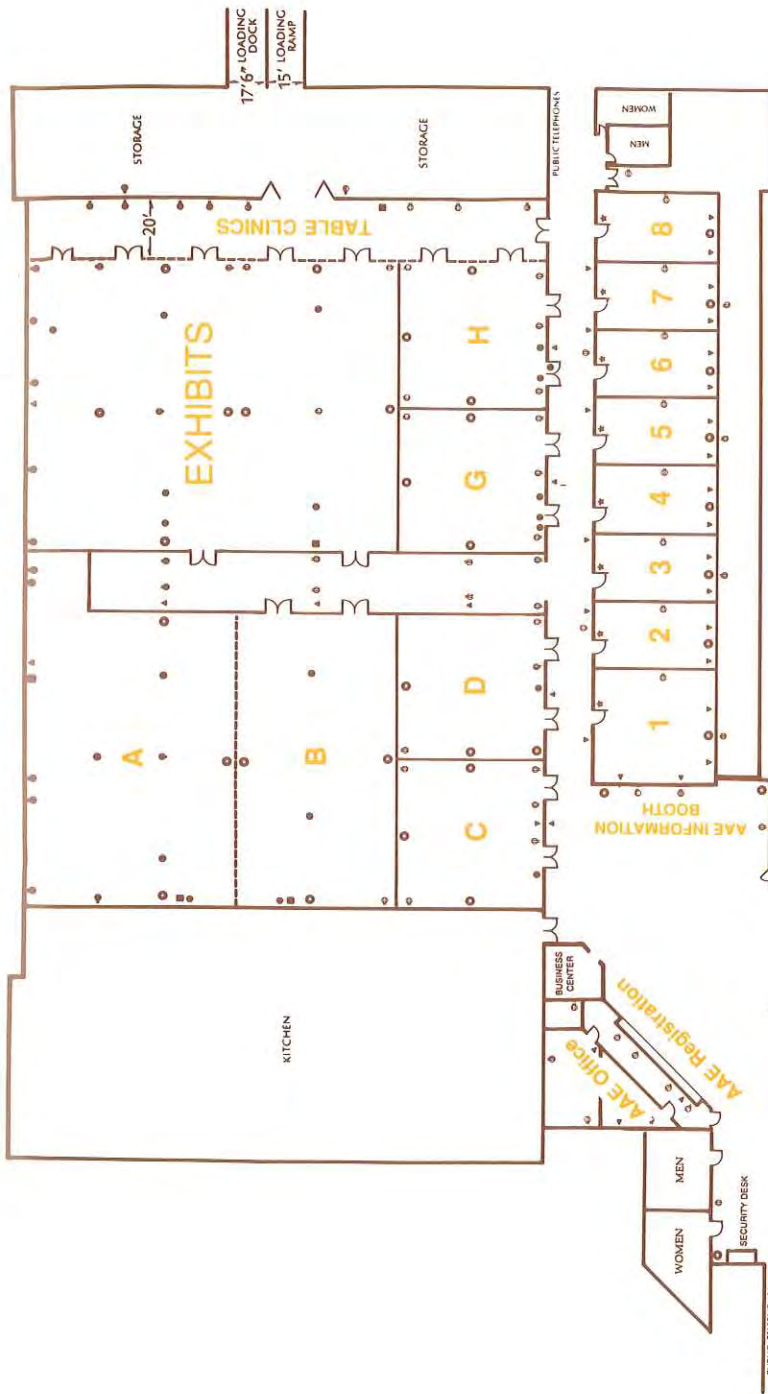



PRINCIPAL SPEAKERS



DARRICK E. ANTELL, MD, DDS,
New York, NY
Attending Staff Physician of
Plastic Surgery at St Luke's/
Roosevelt Hospital, also in
private practice.



ARNOLD H. GARTNER, DDS,
Southfield, MI
Assistant Clinical Professor,
Dept of Endodontics, Univ of
Detroit, also in private practice.



HERBERT SCHILDER, DDS,
Boston, MA
Chairman & Professor, Dept
of Endodontics, Boston Univ,
also in private practice.



RALPH BELLIZZI, DDS,
Ft. Benning, GA
Mentor in Endodontics, Ad-
vanced Education Program in
General Dentistry, US Army
DENTAC.



GREGORY I. ISERMANN, DDS,
MS, Milwaukee, WI
Lecturer, Northwestern Univ,
also in private practice.



HOWARD S. SELDEN, DDS,
Bethlehem, PA
Dental Staff of Muhlenberg
Hospital and Allentown Hospi-
tal, also in private practice.



L. STEPHEN BUCHANAN, DDS,
Santa Barbara, CA
Private practice



LEE M. JAMESON, DDS, MS,
Chicago, IL
Professor & Director of Ad-
vanced Prosthodontics, North-
western Univ, also in private
practice.



SAMUEL SELTZER, DDS,
Philadelphia, PA
Professor Emeritus of
Endodontology, Temple Univ.



EVA C. DAHL, DDS, MA, MS,
LaCrosse, WI
Endodontist/Oral Pathologist
at Gundersen Clinic, also in
private practice.



ROBERT J. MATUSOW, DMD,
MS, Concord, MA
Clinical Professor of Endodontics
Boston Univ, also in private
practice.



SOL SILVERMAN, Jr, DDS, MA,
San Francisco, CA
Professor & Chairman, Division
of Oral Medicine, Univ of
California at San Francisco



GEORGE J. DOHRMANN, MD,
PhD, Chicago, IL
Neurosurgeon at Univ of
Chicago Medical Center.



CARL W. NEWTON, DDS, MSD,
Indianapolis, IN
Professor & Chairman, Dept of
Endodontics, Indiana Univ;
Director, Endodontic Residency
Program, VA Hospital, also in
private practice.



TIM TIMMONS, BA, ThM,
Irvine, CA
Senior Pastor, South Coast
Community Church.



SAMUEL O. DORN, DDS,
Ft. Lauderdale, FL
Chairman of Advanced Endo-
dontics, Dade County Dental
Research Clinic, also in
private practice.



PAULA PERICH, BA,
Chicago, IL
Assistant Executive Director,
Membership & Marketing
Services, American Dental
Assn.



CALVIN D. TORNECK, DDS, MS,
Toronto, Canada
Acting Head, Dept of Endodontics,
Univ of Toronto, also in private
practice.



DAVID D. FRANCISCO, DDS,
MS, Overland Park, KS
Assistant Clinical Professor in
Endodontics, Univ of Missouri,
also in private practice.



JAMES B. ROANE, DDS, MS,
Oklahoma City, OK
Associate Professor & Chair-
man, Dept of Endodontics,
Univ of Oklahoma, also in
private practice.



PARTICIPANTS' INDEX

A

Abbondanza, Claudio, p. 16
Ahmad, Majinah, p. 15
Antell, Darrick E., p. 9
Awramik, Joyce L., p. 17

B

Bahcall, James K., p. 17
Bajalcaliev, Jenny G., p. 17
Barnett, Frederic, pp. 7, 11, 19
Baumgardner, Kirk R., p. 18
Baumgartner, J. Craig, p. 15
Bell, W. Craig, p. 4
Bell, Riki, p. 4
Bellizzi, Ralph, pp. 12, 16
Berberich, Gerhard A., p. 10
Biesterfeld, Robert C., p. 11
Brown, Cecil E. Jr., p. 7
Buchanan, L. Stephen, p. 9
Burns, Richard C., p. 4
Bustamante, Manuel A., p. 17

C

Campbell, Jack P., p. 17
Cervone, Frank J., p. 15
Chapman, Melissa B., p. 10
Chernick, Lester B., p. 7
Chohayeb, Aida A., p. 15
Corcoran, John F., p. 18
Coury, Kirk A., p. 17
Coyne, James G., p. 10
Cummings, Raleigh R., p. 20
Cunningham, Charles J., pp. 4, 12, 20

D

Dahl, Eva C., p. 9
Dietz, Anthony E., p. 4
Dietz, Gerald C. Sr., p. 7
Dietz, Gerald C. Jr., p. 19
Dietz, Pam, p. 4
Dobin, David M., p. 17
Dohrmann, George J., p. 9
Dorn, Samuel O., pp. 7, 13, 19
Dovgan, Joseph S., p. 10
Dryden, James A., pp. 8, 15
Dummer, Paul M. H., p. 15

E

Eckert, Clay S., p. 18
Ehrmann, Ernst H., pp. 15, 16

F

Fonseca, Olga, p. 17
Fouad, Ashraf F., pp. 12, 18
Fournier, Maria J., p. 18
Francisco, David D., pp. 11, 20
Friedman, Shimon, p. 7
Fukawa, Michael R., p. 17
Fuss, Zvi, p. 7

G

Gamm, David J., p. 10
Gardner, Richard J., p. 18
Gartner, Arnold H., p. 7
Gatewood, R. Scott, pp. 13, 19
Gerstein, Harold, p. 19
Gettleman, Bradley H., p. 17
Gianakakis, James F., p. 18
Glickman, Gerald N., pp. 13, 16
Golden, Richard E. Jr., p. 17
Goldman, Melvin, p. 10
Goodis, Harold E., p. 10

H

Halk, Gerald J., p. 10
Hamilton, Richard, p. 13
Hardee, Michael W., p. 10
Harrison, John W., pp. 7, 10
Herweijer, Jantien A., p. 15
Hicks, M. Lamar, p. 9
Hightower, William C., p. 17
Hiltz, James A., p. 18
Himel, Van T., pp. 13, 19
Holland, G. Rex, p. 10
Hoover, Jeffrey, p. 4
Hunter, Kenneth R., p. 17

I

Isermann, Gregory T., pp. 4, 13, 14, 20

J

Jackson, C. Russell, p. 17
Jameson, Lee M., p. 14
Janicek, Jitka M., p. 12
Jeansonne, Michael J., p. 17
Jennings, Carolyn, p. 4
Johnson, Scott A., p. 17
Juhlin, Jon J., p. 18

K

Katsuumi, Ichiroh, p. 18
Keir, Daniel M., p. 12
Kokich, Vincent G., p. 6
Koren, Larry Z., p. 7
Kozlowski, Daniel R., p. 14
Krakow, Alvin A., p. 16
Kulild, James C., pp. 11, 15

L

Laurichesse, Jean-Marie, p. 17
Leeb, I. Joel, p. 11
Lemon, Ronald R., p. 10
Lenroot, Rush A., p. 4
Lento, Christopher A., p. 17
Leseberg, Dennis A., p. 12
Levy, Guy C., pp. 15, 17
Loushine, Robert J., p. 16
Luper, William D., p. 17

M

Machtou, Pierre, pp. 15, 19
Madison, Sandra, pp. 10, 15
Maggio, Joseph D., p. 9
Margolis, Beverly A., p. 22
Mark, Michael L., p. 12
Marshall, F. James, p. 9
Matusow, Robert J., p. 7
Maze, Ben B., p. 4
McClanahan, Scott B., p. 17
McWalter, George M., p. 10
Michaelides, Paul L., p. 6
Micklow, Susan L., p. 12
Miller, Donald A., p. 17
Milnarik, Ronald M., p. 20
Molloy, Daniel J., p. 12
Mori, Katsuei, p. 13
Morrow, Steven G., p. 15
Muldorf, Les H., p. 15
Myers, John W., pp. 8, 16

N

Nelson, Bradley J., p. 4
Nencka, Daniel J., p. 18
Newton, Carl W., pp. 8, 14
Nicholls, Jack I., p. 6
Niemann, Ralph W., p. 17
Nii, Marna M., p. 17
Nist, Robert A., p. 10
Noorvash, Shahab, p. 17

O

Ordon, Katherine, p. 22
Osetek, Edward M., p. 4

P

Paesani, Peter A., p. 20
Pantera, Eugene A. Jr., p. 7
Passloff, Robert W., p. 18
Pecora, Gabriele, p. 16
Perich, Paula, p. 19
Perrini, Nicola, p. 19
Pettersen, Eric A., p. 12
Pitts, David L., p. 12
Piccinino, Michael V., p. 17
Propper, Terry L., p. 10

R

Ratkus, Anne, p. 9
Rauschenberger, Cindy R., p. 10
Ray, Herbert L. Jr., p. 12
Ricci, Catherine R., pp. 15, 17
Rivera, Eric M., p. 7
Roahen, James O., p. 4
Roane, James B., p. 14
Rosenberg, Robert J., pp. 4, 6, 7
Rossman, Louis E., p. 13
Russin, J. Tim, p. 17
Rutledge, Richard E., p. 12

S

Saad, Abdelhamied Y., p. 7
Schilder, Herbert, p. 14
Schweitzer, Jordan L., p. 7
Selden, Howard S., p. 9
Seltzer, Samuel, pp. 10, 14
Shugars, Kevin A., p. 18
Sieraski, Steven A., p. 16
Silverman, Sol Jr., p. 18
Southard, Denny W., p. 13
Southard, Linda Z., p. 13
Spolnik, Kenneth J., p. 8
Spriggs, Kent A., pp. 10, 17
Steiman, H. Robert, pp. 4, 10
Sykes, James D., p. 17

T

Taintor, Jerry F., p. 11
Taylor, Gary N., pp. 11, 19
Tenca, Joseph I., p. 14
Thorpe, Jeffrey R., p. 17
Timmmons, Tim, pp. 9, 22
Toca, David J., p. 17
Todd, Mark W., p. 17
Torabinejad, Mahmoud, pp. 4, 12
Torneck, Calvin D., p. 14
Trattner, Bradley A., p. 17
Trobe, Martin, p. 10
Tsuzuki, Tamiyuki, p. 18
Tuttle, Albert, p. 10

U

Ung, Borasmy N., p. 12

V

Van Hassel, Henry J., p. 8

W

Wagner, Gary W., p. 12
Wagnild, Galen W., p. 6
Walia, Harmeet D., p. 17
Walton, Richard E., p. 15
Weichman, Jack A., p. 14
Weisman, Manuel I., pp. 8, 15
Wenckus, Christopher S., p. 15
Wiemann, Alfred H. III, p. 18
Wilcox, Lisa R., p. 18

Y

Yamauchi, Shizuko, p. 18
Yana, Yves M., p. 10
Yonchak, Thomas A., p. 10

Z

Zelikow, Robert, p. 18



American Association of Endodontists
211 East Chicago Avenue, Suite 1501
Chicago, Illinois 60611